

HP Color LaserJet Enterprise X677 series printers



Product Guide (X677z+ series)

Powerfully
productive.
Extraordinarily
efficient.

The modern workforce demands radical flexibility and agility to collaborate across teams and tasks. Now, you can empower employees with the innovative and efficient HP Color LaserJet Enterprise X677 series MFPs and printers. With robust copier capabilities in print volume, input and finishing options, scanning and print speed performance, and solutions that scale with your business; these redesigned printers are here to support today's business demands and those yet to come. Explore how this managed portfolio is right for your business today.



Everything you expect
from an office printer



Customizable
and scalable solutions



Fast and seamless
digitization



HP WOLF SECURITY

Always on guard with HP
Wolf Security⁵

Get to know the HP Color LaserJet Enterprise X677 series

HP Color LaserJet Enterprise Flow MFP X677z+ shown

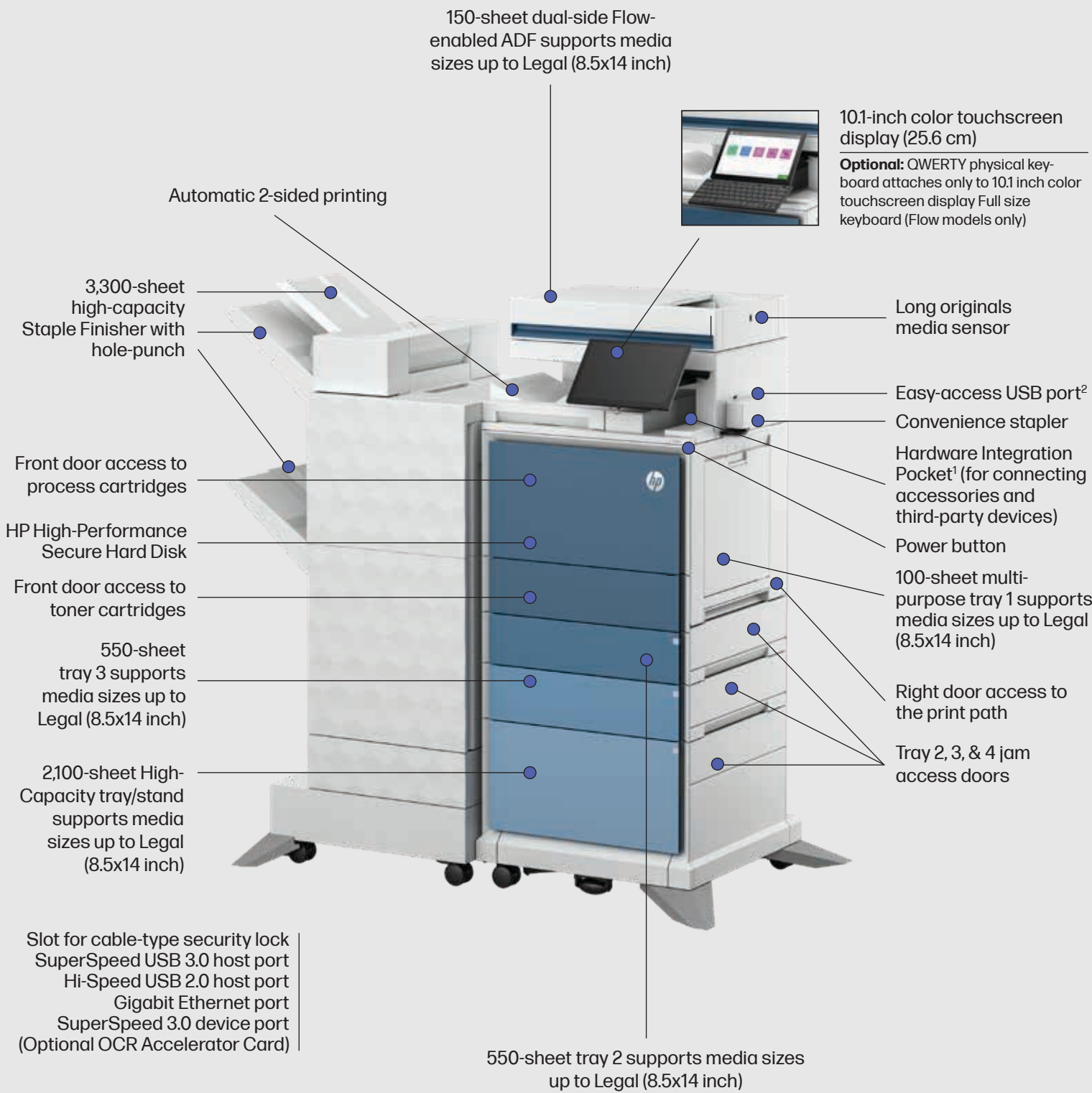

150-sheet dual-side Flow-enabled ADF supports media sizes up to Legal (8.5x14 inch)



10.1-inch color touchscreen display (25.6 cm)

Optional: QWERTY physical keyboard attaches only to 10.1 inch color touchscreen display Full size keyboard (Flow models only)

Automatic 2-sided printing

3,300-sheet high-capacity Staple Finisher with hole-punch

Long originals media sensor

Front door access to process cartridges

Easy-access USB port²

HP High-Performance Secure Hard Disk

Convenience stapler

Front door access to toner cartridges

Hardware Integration Pocket¹ (for connecting accessories and third-party devices)

550-sheet tray 3 supports media sizes up to Legal (8.5x14 inch)

Power button

100-sheet multi-purpose tray 1 supports media sizes up to Legal (8.5x14 inch)

2,100-sheet High-Capacity tray/stand supports media sizes up to Legal (8.5x14 inch)

Right door access to the print path

Tray 2, 3, & 4 jam access doors

Slot for cable-type security lock
 SuperSpeed USB 3.0 host port
 Hi-Speed USB 2.0 host port
 Gigabit Ethernet port
 SuperSpeed 3.0 device port
 (Optional OCR Accelerator Card)

550-sheet tray 2 supports media sizes up to Legal (8.5x14 inch)

Series at a glance



Model	HP Color LaserJet Enterprise MFP X677dn	HP Color LaserJet Enterprise Flow MFP X677zs	HP Color LaserJet Enterprise MFP X677s	HP Color LaserJet Enterprise Flow MFP X677z	HP Color LaserJet Enterprise Flow MFP X677z+
Product number	6QQ01A	6QQ02A	76H08A	76H09A	(6QQ03A + 632P2A)
Functions	Print, copy, and scan (fax and wireless optional) (all models)	Print, copy, and scan (fax and wireless optional) (all models)	Print, copy, and scan (fax and wireless optional) (all models)	Print, copy, and scan (fax and wireless optional) (all models)	Print, copy, and scan (fax and wireless optional) (all models)
Print speed (A4 and Letter, black and color) ³	52/55 ppm (A4/Letter), 61/65 ppm (A4/Letter) with optional speed license	52/55 ppm (A4/Letter), 61/65 ppm (A4/Letter) with optional speed license	52/55 ppm (A4/Letter), 61/65 ppm (A4/Letter) with optional speed license	52/55 ppm (A4/Letter), 61/65 ppm (A4/Letter) with optional speed license	52/55 ppm (A4/Letter), 61/65 ppm (A4/Letter) with optional speed license
Control panel	8-inch color touchscreen display	10.1-inch color touchscreen display	8-inch color touchscreen display	10.1-inch color touchscreen display	10.1-inch color touchscreen display
Scan speed ⁴	80/160 ipm (simplex/duplex)	100/200 ipm (simplex/duplex)	80/160 ipm (simplex/duplex)	100/200 ipm (simplex/duplex)	100/200 ipm (simplex/duplex)
RMPV	Up to 30,000 pages per month	Up to 30,000 pages per month	Up to 30,000 pages per month	Up to 30,000 pages per month	Up to 30,000 pages per month
Input capacity	650/3,300 (std./max.)	1,750/1,750 (std./max.)	650/2,750 (std./max.)	650/2,750 (std./max.)	3,300/3,300 (std./max.)
Output capacity (standard)	500-sheets	1,000-sheets	1,000-sheets	1,000-sheets	3,300-sheets
Processor	Quad-core 1.6 GHz	Quad-core 1.6 GHz	Quad-core 1.6 GHz	Quad-core 1.6 GHz	Quad-core 1.6 GHz
Flow solutions	No	Yes	No	Yes	Yes
Workpath enabled	Yes	Yes	Yes	Yes	Yes
Extensibility	HP FutureSmart 5, OXPd	HP FutureSmart 5, OXPd	HP FutureSmart 5, OXPd	HP FutureSmart 5, OXPd	HP FutureSmart 5, OXPd

Footnotes

1. Solutions deployed through the Hardware Integration Pocket (HIP) may require additional purchase.
2. An administrator must enable the easy-access USB port before use.
3. Measured using ISO/IEC 24734, excludes first set of test documents. For more information, see hp.com/go/printer claims. The exact speed varies depending on the system configuration, software application, driver, and document complexity.
4. Scan speeds measured from ADF. Actual processing speeds may vary depending on scan resolution, network conditions, computer performance, and application software.
5. HP Security is now HP Wolf Security. Security features vary by platform, please see the product data sheet for details.

HP Color LaserJet Enterprise MFP X677dn technical specifications

Processor speed	1.6 GHz			
Orderable supplies	HP W9270MC Black Managed Original LaserJet Toner Cartridge (~44,000 pages) W9270MC; HP W9271MC Cyan Managed Original LaserJet Toner Cartridge (~33,000 pages) W9271MC; HP W9272MC Yellow Managed Original LaserJet Toner Cartridge (~33,000 pages) W9272MC; HP W9273MC Magenta Managed Original LaserJet Toner Cartridge (~33,000 pages) W9273MC; HP W9280MC Black Managed Original LaserJet Imaging Drum (~150,000 pages); HP W9281MC Cyan Managed Original LaserJet Imaging Drum (~150,000 pages); HP W9282MC Yellow Managed Original LaserJet Imaging Drum (~150,000 pages); HP W9283MC Magenta Managed Original LaserJet Imaging Drum (~150,000 pages); HP LaserJet 110V Enhanced Fuser Kit 527G2A; HP LaserJet 220V Enhanced Fuser Kit 527G3A; HP LaserJet Managed 110V Enhanced Fuser Kit 527G4MC; HP LaserJet Managed 220V Enhanced Fuser Kit 527G5MC; HP LaserJet Managed Image Transfer Belt Kit 527H0MC; HP LaserJet Managed Transfer Roller Kit 527H1MC; HP LaserJet Tray 2 Roller Kit 527H2A; HP LaserJet MP Tray Roller Kit 527H3A; HP LaserJet ADF Maintenance Kit 6H122A; HP LaserJet ADF Flow Maintenance Kit 6M1P3A; HP LaserJet Toner Collection Unit 527F9A			
Printer smart software features	Apple AirPrint™, Mopria-certified, Open Extensibility Platform, FutureSmart firmware, Instant-on Technology, HP Auto-On/Auto-Off technology, Easy-access USB, Two-sided Printing, Hardware Integration Pocket, Intuitive 8 in touchscreen control panel, print multiple pages per sheet (2, 4, 6, 9, 16), collation, watermarks, store print jobs, print preview			
Power consumption description	816 watts (Printing/Copying), 63.4 watts (Ready), 11 watts (Sleep), 0.1 watts (Auto Off/Manual On), 0.1 watts (Manual Off)			
Power supply type	Built in 110V or 220 V Power Supply (not dual voltage, power supply varies by part number with option code identifier)			
Power supply required	Input voltage: 100V to 127V nominal (+/-10%), 50 - 60 Hz nominal (+/- 3 Hz), 12 A; Input voltage: 220V to 240V nominal (+/-10%), 50 - 60 Hz nominal (+/-), 6 A			
What's in the box¹	HP Color LaserJet Multifunction Printer; HP Black Original LaserJet Toner Cartridge (~9,000 yield), HP Cyan, Magenta and Yellow Original LaserJet Toner cartridges (~5,000 yield each) (toner cartridges installed); Documentation (Hardware Install Guide); Power cord; Tray Lock Kit (Paper-size cassette locks, paper tray interface screws, P-cartridge door access control screws)			
Supplies feature	TerraJet Cartridge			
Electromagnetic emission standard	CISPR 22:2008 (International) Class A, CISPR 32:2015 (International) Class A / EN 55032:2015 Class A + A1:2020, CISPR 35:2016 (International) / EN 55035:2017 + A1:2020, EN IEC 61000-3-2:2019, EN 61000-3-3:2013+A1:2019 + A2:2021, FCC 47 CFR Part 15 Class A, ICES-003, Issue 7 Class A. Other EMC approvals as required by individual countries.			
Safety approvals and requirements	IEC 60950-1:2005 +A1:2009 +A2:2013 (International); IEC 62368-1:2014; EN 62368-1:2014 (EU); EN 60825-1:2014 +A1:2021/IEC 60825-1:2014 (Class 1 Laser Product); EN 62479:2010/IEC 62479:2010; IEC 62471:2006 / EN 62471:2008; Low Voltage Directive 2014/35/EU with CE Mark (Europe); GS certificate (Germany, Europe); UL/cUL Listed and UC CoC (US/Canada); UL62368-1 2nd Ed. 2014-12-01, CSA C22.2 No. 62368-1-14, 2nd Ed.; Compliance with laser safety standards 21 CFR 1040.10 and 1040.11 except for deviations pursuant to Laser Notice No. 56, dated May 8, 2019; Other safety approvals as required by individual countries.			
ENERGY STAR® certified	Yes			
Ecolabels	CECP; Blue Angel; IT ECO Declaration; SEPA; EPEAT® Gold registered; KOECO			
Blue Angel compliance	Yes, Blue Angel DE-UZ 219—only ensured when using Original HP supplies			
Sustainable impact specifications	15% post-consumer recycled plastic; ENERGY STAR® certified; EPEAT® registered			
Network capabilities	Yes, via HP Jetdirect Ethernet embedded print server (standard) which supports: 10Base-T, 100Base-Tx, 1000Base-T; 802.3az (EEE) support on Fast Ethernet and Gig Links; IPsec (standard); 802.11a/b/g/n wireless networking (optional).			
Supported network protocols	Via built-in networking solution: TCP/IP, IPv4, IPv6; Print: TCP-IP port 9100 Direct Mode, LPD (raw queue support only), Web Services printing, IPP 2.0, Apple AirPrint™, FTP Print, Google Cloud Print; Discovery: SLP, Bonjour, Web Services Discovery; IP Config: IPv4 (BootP, DHCP, AutoIP, Manual, TFTP Config, ARP-Ping), IPv6 (Stateless Link-Local and via Router, Stateful via DHCPv6); Management: SNMPv2/v3, HTTP/HTTPS, Telnet, TFTP Config, FTP FW Download, Syslog; Security: SNMPv3, SSL Cert Management, Firewall, ACL, 802.1x			
Mobile printing capability	Apple AirPrint™; Mopria™ certified; NFC touch-to-print (optional)			
Copier reduce/enlarge	25 to 400%			
Max. number of copies	Up to 9,999			
Copy resolution	Black text	Up to 600 x 600 dpi		
	Color, text, and graphics	Up to 600 x 600 dpi		
Copy speed	Black	A4	Up to 52 cpm; Up to 61 cpm (with 49K94AAE)	
		Letter	Up to 55 cpm; Up to 65 cpm (with 49K94AAE)	
	Color	A4	Up to 52 cpm; Up to 61 cpm (with 49K94AAE)	
		Letter	Up to 55 cpm; Up to 65 cpm (with 49K94AAE)	
Digital sending standard features	Scan to Email; Scan to Network Folder; Scan to USB Drive; Scan to SharePoint; scan to FTP; Scan to SFTP; Scan to LAN fax; scan to Internet Fax; local address book; SMTP over SSL; automatically detect color/monochrome; high compression PDF; image adjustments (darkness, contrast, background cleanup, sharpness); optimize text/picture (text, mixed, printed picture, photograph); content orientation; scan mode (book, 2-sided ID); erase edges; auto page crop; job build; image preview; blank page suppression; automatically straighten			
Package dimensions	Imperial	29.80 x 23.50 x 35.60 in	Metric	758 x 598 x 905 mm
Max. dimensions	Imperial	33.9 x 32.3 x 40.0 in	Metric	860 x 820 x1016 mm

HP Color LaserJet Enterprise MFP X677dn technical specifications

Product dimensions	Imperial	19.7 x 18.1 x 30.3 in		Metric	500 x 460 x 771 mm
Display description	8.0-in (20.3 cm) Color Graphics Display (CGD) with touchscreen; rotating (adjustable angle) display				
Acoustic power emissions	Active, printing	6.6 B(A)			
Acoustic pressure emissions bystander	Ready	20 dB(A)			
Operating humidity range	10 to 80% RH				
Operating humidity range (recommended)	30 to 70% RH				
Operating temperature range	Celsius: 10 to 32.5°C	Recommended celsius: 15 to 27°C	Fahrenheit: 50 to 91°F	Recommended fahrenheit: 59 to 80.6°F	
Storage temperature range	Celsius: -20 to 40°C		Fahrenheit: -4 to 104°F		
Fax	Optional				
Fax speed	Letter: 3 sec per page	Up to 33.6 kbps			
Memory	Standard: 6 GB	Maximum: 6 GB			
Print resolution technologies	HP ImageREt 4800, Fine Lines (1200x1200 dpi), Quickview (300x300 dpi)				
Print speed	A4 Black: Up to 52 ppm; Up to 61 ppm (with 49K94AAE)	Letter Black: Up to 55 ppm; Up to 65 ppm (with 49K94AAE)	A4 Color: Up to 52 ppm; Up to 61 ppm (with 49K94AAE)	Letter Color: Up to 55 ppm; Up to 65 ppm (with 49K94AAE)	
First page out	Black	A4, ready	As fast as 6.2 sec; As fast as 5.5 sec (with 49K94AAE)		
		Letter, ready	As fast as 6.0 sec; As fast as 5.4 sec (with 49K94AAE)		
	Color	A4, ready	As fast as 6.8 sec; As fast as 5.9 sec (with 49K94AAE)		
		Letter, ready	As fast as 6.5 sec; As fast as 5.8 sec (with 49K94AAE)		
Duty cycle	A4	Monthly	Up to 180,000 pages		
	Letter	Monthly	Up to 180,000 pages		
Recommended monthly page volume	Up to 30,000 pages				
Fonts and typefaces	105 internal TrueType fonts scalable in HP PCL, 92 internal scalable fonts in HP postscript level 3 emulation (Euro symbol built-in); 1 internal Unicode fonts (Andale Mono World Type); 2 internal Windows Vista 8 fonts (Calibri, Cambria); additional font solutions available via third-party flash memory cards; HP LaserJet Fonts and IPDS Emulation available at https://www.hp.com/go/laserjetfonts				
Hard disk	Standard, minimum 500 GB HDD				
Print languages, standard	HP PCL 6; HP PCL 5c; HP postscript level 3 emulation, native PDF printing (v 1.7)				
Printer management	HP Web Jetadmin; Embedded Web Server; HP Security Manager; HP Insights; HP Advance; HP Command Center; HP Smart Device Services (SDS)				
Top key features	Automatic Document Feeder; Touchscreen; Stapling; TerraJet Cartridge				
Target number of users and print volume	For teams over 25 users; prints up to 30,000 pages/month				
AIO Functions	Print, copy, scan, fax (optional)				
Duplex print options	Automatic				
Print technology	Laser				
Paper trays, standard	2				
Input capacity	Standard: Up to 650 sheets				
Output capacity	Standard: Up to 500 Sheets				
Media type and capacity tray 1	Paper: 100 sheets of 75 g/m ² media		Envelopes: 10		
Paper handling standard	Input: 550-sheet input tray, 100-sheet multi-purpose tray		Output: 500-sheet output tray		
Input capacity, Max, envelopes	MP Tray: Up to 10 envelopes (or 10 mm stack height)				
Product short name	X677				
Typical Electricity Consumption (TEC) number	0.849 kWh/week (ENERGY STAR 3.0); 0.810 kWh/week (Blue Angel)				
Number of simultaneous users (local + network)	10-30 users				
Scan resolution	Hardware: Up to 600 x 600 dpi		Optical: Up to 600 dpi		Enhanced: Up to 600 dpi
Scan speed (normal, A4)	Up to 76 ppm/152 ipm (b&w), up to 76 ppm/152 ipm (color); Up to 76 ppm/152 ipm (b&w), up to 76 ppm/152 ipm (color) (with 49K94AAE)				
Automatic Document Feeder (ADF) capacity	Standard, 150 sheets				
Color scanning	Yes				
Grayscale levels	256				
Scan input modes	Front panel applications: Copy; Fax; Scan to Email; Scan to Network Folder; Scan to USB; Scan to Job Storage; Open Extensibility Platform (EXP), HP Workpath applications				

HP Color LaserJet Enterprise MFP X677dn technical specifications

Scan size	Maximum	ADF, Metric	216 x 864 mm	Minimum	ADF, Metric	68 x 148 mm
		ADF, Imperial	8.5 x 34.0 in		ADF, Imperial	2.7 x 5.8 in
		Flatbed, Metric	216 x 356 mm			
		Flatbed, Imperial	8.5 x 14.0 in			
Bit depth	24-bit					
TWAIN Version	Version 2.4					
Scan File Format	PDF; PDF/A; TIFF; Hi-Compression PDF; MTIFF; XPS; JPEG					
Scan Type	Flatbed; ADF					
Security management	Identity management: Kerberos authentication; LDAP authentication; 1,000 user pin codes; optional HP and 3 rd party advanced authentication solutions (e.g. badge readers); Network: IPsec/firewall with certificate; pre-shared key; Supports WJA-10 IPsec configuration Plug-in; 802.1x authentication (EAP-PEAP; EAP-TLS); SNMPv3; HTTPS; Certificates; Access Control List; Data: Storage Encryption; Encrypted PDF & Email (uses FIPS 140 validated cryptographic libraries from Microsoft); Secure Erase; SSL/TLS (HTTPS); Encrypted Credentials; Device: Security lock slot; USB port disablement; Hardware Integration Pocket for security solutions; Intrusion Detection with Red Balloon Security Technology - Constant in-device monitoring for attacks; SureStart Secure Boot - BIOS Integrity Checking with self-healing capability; Whitelisting - loads only known good code (DLLs, ExEs, ...); Security management: Compatible with Device Security Syslog Messages processed and accessible in ArcSight and Splunk SIEMs					
Mac compatible	Yes					
Software included	No software solutions are included in the box, only on http://hp.com http://123.hp.com					
Media types	Paper (plain, light, intermediate, light bond, bond, recycled, mid-weight, heavy, mid-weight glossy, heavy glossy, extra heavy, extra heavy glossy, cardstock, card glossy), color transparency, labels, letterhead, envelope, pre-printed, pre-punched, colored, rough, opaque film, user-defined					
Standard media sizes supported	Metric	Tray 1: A4, A5, A6, RA4, B5, B6, 16k, 10 x 15 cm, Oficio, postcards (JIS single and double) envelopes (DL, C5, B5, C6); Tray 2, optional 1x550-sheet feeders: A4, A5, A6, RA4, B5, B6, 10 x 15 cm, Oficio, 16k, Dpostcard (JIS); optional 2,100-sheet high-capacity feeder: A4; A5 (with optional accessory)				
	Imperial	Tray 1: letter, legal, executive, statement, Oficio, 3 x 5 in, 4 x 6 in, 5 x 7 in, 5 x 8 in, envelopes (No. 9, No. 10, Monarch); Tray 2, optional 1x550-sheet feeders: letter, legal, executive, statement, Oficio, 4 x 6 in, 5 x 7 in, 5 x 8 in; optional 2,100-sheet high-capacity feeder: Letter, Legal; Statement (with optional accessory)				
Media sizes custom	Metric	Tray 1: 2.52 x 5 to 8.5 x 47.24 in; Tray 2, optional 1x550-sheet feeders: 4 x 5.83 to 8.5 x 14 in; optional 2,100-sheet high-capacity feeder: custom sizes not supported in this tray				
	Imperial	Tray 1: 2.52 x 5 to 8.5 x 47.24 in; Tray 2, optional 1x550-sheet feeders: 4 x 5.83 to 8.5 x 14 in; optional 2,100-sheet high-capacity feeder: custom sizes not supported in this tray				
Media size, tray 1	Metric	A4, A5, A6, RA4, B5, B6, 10 x 15 cm, Oficio 216 x 340, 16k, Postcard (JIS), DPostcard (JIS), Envelopes (DL, C5, B5, C6); custom 64 x 127 to 216 x 1200 mm				
Media weights supported	By paper path	Metric	Tray 1: 60 to 220 g/m ² (plain), 120 to 220 g/m ² (glossy); Tray 2: 60 to 220 g/m ² (plain), 120 to 220 g/m ² (glossy); optional 550-sheet input tray: 60 to 220 g/m ² (plain), 120 to 220 g/m ² (glossy); optional 2,100-sheet high capacity input: 60-220 g/m ² (plain)			
		Imperial	Tray 1: 16 to 58 lb (plain), 32 to 58 lb (glossy); Tray 2: 16 to 58 lb (plain), 32 to 58 lb (glossy); optional 550-sheet input trays: 16 to 58 lb (plain), 32 to 58 lb (glossy); optional 2,100-sheet high-capacity input: 16 to 58 lb (plain)			
	ADF	Metric	45 to 199 g/m ²			
		Imperial	12 to 53 lb			
	Tray 1	Metric	60 to 220 g/m ² (plain), 120 to 220 g/m ² (glossy)			
Media size, ADF	Letter; Legal; Oficio; Executive; Statement; 16K; A4; RA4; A5; A6; B5; B6 (JIS); Postcard (JIS); DPostcard (JIS); 4 x 6 in; 5 x 7 in; 5 x 8 in; 68 x 147 mm to 215.9 x 863.6 mm; 2.68 x 5.79 in to 8.46 x 34 in					
Key media sizes supported	Metric	A4				
	Imperial	Letter; Legal				
Control panel	8.0 in (20.3 cm) Color Graphics Display (CGD) with touchscreen; rotating (adjustable angle) display					
System requirements, Macintosh, minimum	2 GB available hard drive space; Internet connection; or USB port; Internet browser; For additional OS hardware requirements, see apple.com					
System requirements, minimum	2 GB available hard disk space; Internet connection; or USB port; Internet browser; For additional OS hardware requirements, see microsoft.com					
Manufacturer warranty	Value is confirmed One-year Next Business Day Onsite Warranty. Warranty and support options vary by product, country, and local legal requirements. Go to http://hp.com/support to learn about HP award-winning service and support options in your region.					
Weight	Metric	50.35 kg			Imperial	110.77 lb
Package weight	Metric	74.60 kg			Imperial	164.00 lb

HP Color LaserJet Enterprise Flow MFP X677zs technical specifications

Processor speed	1.6 GHz					
Orderable supplies	HP W9270MC Black Managed Original LaserJet Toner Cartridge (~44,000 pages) W9270MC; HP W9271MC Cyan Managed Original LaserJet Toner Cartridge (~33,000 pages) W9271MC; HP W9272MC Yellow Managed Original LaserJet Toner Cartridge (~33,000 pages) W9272MC; HP W9273MC Magenta Managed Original LaserJet Toner Cartridge (~33,000 pages) W9273MC; HP W9280MC Black Managed Original LaserJet Imaging Drum (~150,000 pages); HP W9281MC Cyan Managed Original LaserJet Imaging Drum (~150,000 pages); HP W9282MC Yellow Managed Original LaserJet Imaging Drum (~150,000 pages); HP W9283MC Magenta Managed Original LaserJet Imaging Drum (~150,000 pages); HP LaserJet 110V Enhanced Fuser Kit 527G2A; HP LaserJet 220V Enhanced Fuser Kit 527G3A; HP LaserJet Managed 110V Enhanced Fuser Kit 527G4MC; HP LaserJet Managed 220V Enhanced Fuser Kit 527G5MC; HP LaserJet Managed Image Transfer Belt Kit 527H0MC; HP LaserJet Managed Transfer Roller Kit 527H1MC; HP LaserJet Tray 2 Roller Kit 527H2A; HP LaserJet MP Tray Roller Kit 527H3A; HP LaserJet ADF Maintenance Kit 6H122A; HP LaserJet ADF Flow Maintenance Kit 6M1P3A; HP LaserJet Toner Collection Unit 527F9A; HP Staple Cartridge Refill (5,000 staples) J8J96A					
Printer smart software features	Apple AirPrint™, Mopria-certified, Open Extensibility Platform, FutureSmart firmware, Instant-on Technology, HP Auto-On/Auto-Off technology, Easy-access USB, Two-sided Printing, Hardware Integration Pocket, Intuitive 10.1 in touchscreen control panel, print multiple pages per sheet (2, 4, 6, 9, 16), collation, watermarks, store print jobs, print preview					
Power consumption description	816 watts (Printing/Copying), 63.4 watts (Ready), 11 watts (Sleep), 0.1 watts (Auto off/Manual on), 0.1 watts (Manual off)					
Power supply type	Built in 110V or 220V Power Supply (not dual voltage, power supply varies by part number with option code identifier)					
Power supply required	Input voltage: 100V to 127 V nominal (+/-10%), 50 - 60 Hz nominal (+/- 3 Hz), 12 A; Input voltage: 220 V to 240 V nominal (+/-10%), 50 - 60 Hz nominal (+/- 3 Hz), 6 A					
What's in the box	HP Color LaserJet Multifunction Printer; HP Black Original LaserJet Toner Cartridge (~9,000 yield), HP Cyan, Magenta and Yellow Original LaserJet Toner cartridges (~5,000 yield each) (toner cartridges installed); Documentation (Hardware Install Guide); Power cord; Tray Lock Kit (Paper-size cassette locks, paper tray interface screws, P-cartridge door access control screws)					
Supplies feature	TerraJet Cartridge					
Electromagnetic emission standard	CISPR 22:2008 (International) Class A, CISPR 32:2015 (International) Class A / EN 55032:2015 Class A + A1:2020, CISPR 35:2016 (International) / EN 55035:2017 + A1:2020, EN IEC 61000-3-2:2019, EN 61000-3-3:2013+A1:2019 + A2:2021, FCC 47 CFR Part 15 Class A, ICES-003, Issue 7 Class A. Other EMC approvals as required by individual countries.					
Safety approvals and requirements	IEC 60950-1:2005 +A1:2009 +A2:2013 (International); IEC 62368-1:2014; EN 62368-1:2014 (EU); EN 60825-1:2014 +A1:2021/IEC 60825-1:2014 (Class 1 Laser Product); EN 62479:2010/IEC 62479:2010; IEC 62471:2006 / EN 62471:2008; Low Voltage Directive 2014/35/EU with CE Mark (Europe); GS Certificate (Germany, Europe); UL/cUL Listed and UC CoC (US/Canada); UL 62368-1 2nd Ed. 2014-12-01, CSA C22.2 No. 62368-1-14, 2nd Ed.; Compliance with laser safety standards 21 CFR 1040.10 and 1040.11 except for deviations pursuant to laser Notice No. 56, dated May 8, 2019. Other safety approvals as required by individual countries.					
ENERGY STAR® certified	Yes					
Ecolabels ³	CECP; IT ECO Declaration; Blue Angel; SEPA; EPEAT® Gold registered; KOECO					
Blue Angel compliance	Yes, Blue Angel DE-UZ 219—only ensured when using Original HP supplies					
Sustainable impact specifications	15% post-consumer recycled plastic; ENERGY STAR® certified; EPEAT® registered					
Network capabilities	Yes, via HP Jetdirect Ethernet embedded print server (standard) which supports: 10Base-T, 100Base-Tx, 1000Base-T; 802.3az (EEE) support on Fast Ethernet and Gig Links; IPsec (standard); 802.11a/b/g/n wireless networking (optional).					
Supported network protocols	Via built-in networking solution: TCP/IP, IPv4, IPv6; Print: TCP-IP port 9100 Direct Mode, LPD (raw queue support only), Web Services Printing, IPP 2.0, Apple AirPrint™, FTP Print, Google Cloud Print; Discovery: SLP, Bonjour, Web Services Discovery; IP Config: IPv4 (BootP, DHCP, AutoIP, Manual, TFTP Config, ARP-Ping), IPv6 (Stateless Link-Local and via Router, Stateful via DHCPv6); Management: SNMPv2/v3, HTTP/HTTPS, Telnet, TFTP Config, FTP FW Download, Syslog; Security: SNMPv3, SSL Cert Management, Firewall, ACL, 802.1x					
Mobile printing capability	Apple AirPrint™; Mopria™ certified; NFC touch-to-print (optional)					
Copier reduce/enlarge	25 to 400%					
Max. number of copies	Up to 9,999					
Copy resolution	Black text		Up to 600 x 600 dpi			
	Color, text, and graphics		Up to 600 x 600 dpi			
Copy speed	Black	A4	Up to 52 cpm; Up to 61 cpm (with 49K94AAE)			
		Letter	Up to 55 cpm; Up to 65 cpm (with 49K94AAE)			
	Color	A4	Up to 52 cpm; Up to 61 cpm (with 49K94AAE)			
		Letter	Up to 55 cpm; Up to 65 cpm (with 49K94AAE)			
Digital sending standard features	Scan to Email; Scan to Network Folder; Scan to USB Drive; Scan to SharePoint; Scan to FTP; Scan to sFTP; Scan to LAN fax; Scan to Internet Fax; Local address book; SMTP over SSL; automatically detect color/monochrome; high compression PDF; image adjustments (darkness, contrast, background cleanup, sharpness); optimize text/picture (text, mixed, printed picture, photograph); content orientation; scan mode (book, 2-sided ID); erase edges; auto page crop; job build; image preview; blank page suppression; automatically straighten; embedded OCR; optimize text/picture (auto); scan to multi-destination; automatic tone; auto orientation; multi-feed detection; Reverse and Retry; document editing; auto paper color removal; job separation (blank page, barcode); watermark; stamps					
Package dimensions	Imperial	31.10 x 29.92 x 58.03 in		Metric	790 x 760 x 1474 mm	
Max. dimensions	Imperial	34.3 x 32.4 x 59.8 in		Metric	870 x 823 x 1519 mm	

HP Color LaserJet Enterprise Flow MFP X677zs technical specifications

Product dimensions	Imperial	20.5 x 20.8 x 50.2 in		Metric	520 x 528 x 1274 mm
Display description	10.1-in Color Graphics Display (CGD) with touchscreen; rotating (adjustable angle) display				
Acoustic pressure emissions bystander	Ready	19 dB(A)			
Operating humidity range	10 to 80% RH				
Operating humidity range (recommended)	30 to 70% RH				
Operating temperature range	Celsius: 10 to 32.5°C	Recommended celsius: 15 to 27°C	Fahrenheit: 50 to 91°F	Recommended fahrenheit: 59 to 80.6°F	
Storage temperature range	Celsius: -20 to 40°C		Fahrenheit: -4 to 104°F		
Fax	Optional				
Fax speed	Letter: 3 sec per page	Up to 33.6 kbps			
Memory	Standard: 6 GB	Maximum: 6 GB			
Print resolution technologies	HP ImageREt 4800, Fine Lines (1200 x 1200 dpi), Quickview (300 x 300 dpi)				
Print speed	A4 Black: Up to 52 ppm; Up to 61 ppm (with 49K94AAE)	Letter Black: Up to 55 ppm; Up to 65 ppm (with 49K94AAE)	A4 Color: Up to 52 ppm; Up to 61 ppm (with 49K94AAE)	Letter Color: Up to 55 ppm; Up to 65 ppm (with 49K94AAE)	
First page out	Black	A4, ready	As fast as 6.6 sec; As fast as 6.5 sec (with 49K94AAE)		
		Letter, ready	As fast as 6.5 sec; As fast as 6.4 sec (with 49K94AAE)		
	Color	A4, ready	As fast as 7.4 sec; As fast as 7.1 sec (with 49K94AAE)		
		Letter, ready	As fast as 7.3 sec; As fast as 6.9 sec (with 49K94AAE)		
Duty cycle	A4	Monthly	Up to 180,000 pages		
	Letter	Monthly	Up to 180,000 pages		
Recommended monthly page volume	4,000 to 30,000				
Fonts and typefaces	105 internal TrueType fonts scalable in HP PCL, 92 internal scalable fonts in HP postscript level 3 emulation (Euro symbol built-in); 1 internal Unicode fonts (Andale Mono WorldType); 2 Internal Windows Vista 8 fonts (Calibri, Cambria); additional font solutions available via third-party flash memory cards; HP LaserJet Fonts and IPDS Emulation available at https://www.hp.com/go/laserjetfonts				
Hard disk	Standard, minimum 500 GB HDD				
Print languages, standard	HP PCL 6, HP PCL 5, HP PostScript level 3 emulation, native PDF printing (v 1.7), Apple AirPrint™				
Printer management	HP Web Jetadmin; Embedded Web Server; HP Security Manager; HP Insights; HP Advance; HP Command Center; HP Smart Device Services (SDS)				
Top key features	Flow; Touchscreen; Stapling; TerraJet cartridge				
Target number of users and print volume	For teams over 25 users; prints up to 30,000 pages/month				
AIO Functions	Print, copy, scan, fax (optional)				
Duplex print options	Automatic				
Print technology	Laser				
Paper trays, standard	4				
Input capacity	Standard: up to 1,750 sheets				
Output capacity	Standard: Up to 1,000 sheets				
Media type and capacity tray 1	Paper: 100 sheets of 75 g/m² media		Envelopes: 10		
Paper handling standard	Input: 3x550-sheet input tray, 100-sheet multi-purpose tray		Output: 500-sheet output tray, 500-sheet output stapler stacker, two-sided printing		
Product short name	X677				
Typical Electricity Consumption (TEC) number	0.849 kWh/week (ENERGY STAR 3.0); 0.810 kWh/week (Blue Angel)				
Number of simultaneous users (local + network)	10-30 users				
Scan resolution	Hardware: Up to 600 x 600 dpi		Optical: Up to 600 dpi		Enhanced: Up to 600 dpi
Scan speed (normal, A4)	Up to 95 ppm/190 ipm (b&w), up to 95 ppm/190 ipm (color); Up to 95 ppm/190 ipm (b&w), up to 95 ppm/190 ipm (color) (with 49K94AAE)				
Automatic Document Feeder (ADF) capacity	Standard, 150 sheets				
Color scanning	Yes				
Grayscale levels	256				
Scan input modes	Front panel applications: Copy; Fax; Scan to Email; Scan to Network Folder; Scan to USB; Scan to Job Storage; Open Extensibility Platform (OXP), HP Workpath applications				

HP Color LaserJet Enterprise Flow MFP X677zs technical specifications

Scan size	Maximum	ADF, metric	216 x 864 mm	Minimum	ADF, metric	68 x 127 mm
		ADF, imperial	8.5 x 34.0 in		ADF, imperial	2.7 x 5.0 in
	Flatbed, metric	216 x 356 mm	Flatbed, imperial	8.5 x 14.0 in		
Bit depth	24-bit					
TWAIN Version	Version 2.4					
Scan File Format	PDF; Hi-Compression PDF; PDF/A; JPEG; TIFF; MTIFF; XPS					
Scan Type	Flatbed, ADF					
Security management	Identity management: Kerberos authentication; LDAP authentication; 1000 user pin codes; optional HP and 3 rd party advanced authentication solutions (e.g.; badge readers); Network: IPsec/firewall with certificate; pre-shared Key; Supports WJA-10 IPsec configuration Plug-in; 802.1X authentication (EAP-PEAP; EAP-TLS); SNMPv3; HTTPS; certificates; Access Control List; Data: Storage Encryption; Encrypted PDF & Email (uses FIPS 140 validated cryptographic libraries from Microsoft); Secure Erase; SSL/TLS (HTTPS); Encrypted credentials; Device: Security lock slot; USB port disablement; Hardware Integration Pocket for security solutions; Intrusion Detection with Red Balloon Security Technology - Constant in-device monitoring for attacks; Sure Start Secure Boot - BIOS Integrity Checking with self-healing capability; Whitelisting - loads only known good code (DLLs, EXEs, ...); Security management: Compatible with Device Security Syslog Messages processed and accessible in ArcSight and Splunk SIEMs					
Mac compatible	Yes					
Software included	No software solutions are included in the box, only on http://hp.com http://123.hp.com					
Media types	Paper (plain, light, intermediate, light bond, bond, recycled, mid-weight, heavy, mid-weight glossy, heavy glossy, extra heavy, extra heavy glossy, cardstock, card glossy), color transparency, labels, letterhead, envelope, pre-printed, pre-punched, colored, rough, opaque film, user-defined					
Standard media sizes supported	Metric	Tray 1: A4, A5, A6, RA4, B5, B6, 16k, 10 x 15 cm, Oficio, postcards (JIS single and double) envelopes (DL, C5, B5, C6); Tray 2, Tray 3, Tray 4: A4, A5, A6, RA4, B5, B6, 10 x 15 cm, Oficio, 16k, Dpostcard (JIS)				
	Imperial	Tray 1: Letter, Legal, Executive, Statement, Oficio, 3 x 5 in, 4 x 6 in, 5 x 7 in, 5 x 8 in, envelopes (No. 9, No. 10, Monarch); Tray 2, Tray 3, Tray 4: Letter, Legal, Executive, Statement, Oficio, 4 x 6 in, 5 x 7 in, 5 x 8 in				
Media sizes custom	Metric	Tray 1: 64 x 127 to 216 x 1200 mm; Tray 2, Tray 3, Tray 4: 101 x 148 to 216 x 356 mm				
	Imperial	Tray 1: 2.52 x 5 to 8.5 x 47.24 in; Tray 2, Tray 3, Tray 4: 4 x 5.83 to 8.5 x 14 in				
Media size, tray 1	Metric	A4, A5, A6, RA4, B5, B6, 10 x 15 cm, Oficio 216 x 340, 16k, Postcard (JIS), DPostcard (JIS), Envelopes (DL, C5, B5, C6); custom 64 x 127 to 216 x 1200 mm				
Media weights supported	By paper path	Metric	Tray 1: 60 to 220 g/m ² (plain), 120 to 220 g/m ² (glossy); Tray 2: 60 to 220 g/m ² (plain), 120 to 220 g/m ² (glossy); optional 550-sheet input trays: 60 to 220 g/m ² (plain), 120 to 220 g/m ² (glossy); optional 2,100-sheet high-capacity input: 60 to 220 g/m ² (plain)			
		Imperial	Tray 1: 16 to 58 lb (plain), 32 to 58 lb (glossy); Tray 2: 16 to 58 lb (plain), 32 to 58 lb (glossy); optional 550-sheet input trays: 16 to 58 lb (plain), 32 to 58 lb (glossy); optional 2,100-sheet high-capacity input: 16 to 58 lb (plain)			
	ADF	Metric	12 to 53 lb			
		Imperial	45 to 199 g/m ²			
Tray 1	Metric	60 to 220 g/m ² (plain), 120 to 220 g/m ² (glossy)				
Media size, ADF	Letter; Legal; Oficio; Executive; Statement; 16K; A4; RA4; A5; A6; B5; B6 (JIS); Postcard (JIS); DPostcard (JIS); 4 x 6 in; 5 x 7 in; 5 x 8 in; 68 x 147 mm to 215.9 x 863.6 mm; 2.68 x 5.79 in to 8.46 x 34 in					
Key media sizes supported	Metric	A4				
	Imperial	Letter; Legal				
Control panel	10.1-in Color Graphics Display (CGD) with touchscreen; rotating (adjustable angle) display					
System requirements, Macintosh, minimum	2 GB available hard drive space; Internet connection; or USB port; Internet browser; For additional OS hardware requirements, see apple.com					
System requirements, minimum	2 GB available hard disk space; Internet connection; or USB port; Internet browser; For additional OS hardware requirements, see microsoft.com					
Manufacturer warranty	One-year Next Business Day Onsite Warranty. Warranty and support options vary by product, country, and local legal requirements. Go to http://hp.com/support to learn about HP award-winning service and support options in your region.					
Weight	Metric	84.70 kg			Imperial	186.34 lb
Package weight	Metric	95.60 kg			Imperial	210.32 lb

HP Color LaserJet Enterprise MFP X677s technical specifications

Processor speed	1.6 GHz			
Orderable supplies	HP W9270MC Black Managed Original LaserJet Toner Cartridge (~44,000 pages); HP W9271MC Cyan Managed Original LaserJet Toner Cartridge (~33,000 pages); HP W9272MC Yellow Managed Original LaserJet Toner Cartridge (~33,000 pages); HP W9273MC Magenta Managed Original LaserJet Toner Cartridge (~33,000 pages); HP W9280MC Black Managed Original LaserJet Imaging Drum (~150,000 pages); HP W9281MC Cyan Managed Original LaserJet Imaging Drum (~150,000 pages); HP W9282MC Yellow Managed Original LaserJet Imaging Drum (~150,000 pages); HP W9283MC Magenta Managed Original LaserJet Imaging Drum (~150,000 pages); HP LaserJet 110V Enhanced Fuser Kit 527G2A; HP LaserJet 220V Enhanced Fuser Kit 527G3A; HP LaserJet Managed 110V Enhanced Fuser Kit 527G4MC; HP LaserJet Managed 220V Enhanced Fuser Kit 527G5MC; HP LaserJet Managed Image Transfer Belt Kit 527H0MC; HP LaserJet Managed Transfer Roller Kit 527H1MC; HP LaserJet Tray 2 Roller Kit 527H2A; HP LaserJet MP Tray Roller Kit 527H3A; HP LaserJet ADF Maintenance Kit 6H122A; HP LaserJet ADF Flow Maintenance Kit 6M1P3A; HP LaserJet Toner Collection Unit 527F9A; HP Staple Cartridge Refill (5,000 staples) J8J96A			
Printer smart software features	Apple AirPrint™, Mopria-certified, Open Extensibility Platform, FutureSmart firmware, Instant-on Technology, HP Auto-On/Auto-Off technology, Easy-access USB, Two-sided printing, Hardware Integration Pocket, Intuitive 8-in touchscreen control panel, print multiple pages per sheet (2, 4, 6, 9, 16), collation, watermarks, store print jobs, print preview			
Power consumption description	816 watts (Printing/Copying), 63.4 watts (Ready), 11 watts (Sleep), 01 watts (Auto off/Manual on), 01 watts (Manual off)			
Power supply type	Built in 110V or 220V power supply (not dual voltage, power supply varies by part number with option code identifier)			
Power supply required	Input voltage: 100V to 127V nominal (+/-10%), 50 - 60 Hz nominal (+/- 3 Hz), 12 A; Input voltage: 220 V to 240V nominal, (+/-10%) 50 - 60 Hz nominal (+/- 3 Hz), 6 A			
What's in the box	HP Color LaserJet Multifunction Printer; HP Black Original LaserJet Toner Cartridge (~9,000 yield), HP Cyan, Magenta, and Yellow Original LaserJet Toner Cartridges (~5,000 yield each) (toner cartridges installed); Documentation (Hardware Installation guide); Power cord; Tray Lock Kit (Paper-size cassette locks, paper tray interface screws, P-cartridge door access control screws)			
Supplies feature	TerraJet Cartridge			
Electromagnetic emission standard	CISPR 22:2008 (International) Class A, CISPR 32:2015 (International) Class A / EN 55032:2015 Class A + A11:2020, CISPR 35:2016 (International) / EN 55035:2017 + A11:2020, EN IEC 61000-3-2:2019, EN 61000-3-3:2013+A1:2019 + A2:2021, FCC 47 CFR Part 15 Class A, ICES-003, Issue 7 Class A. Other EMC approvals as required by individual countries.			
Safety approvals and requirements	IEC 60950-1:2005 + A1:2009 + A2:2013 (International); IEC 62368-1:2014; EN 62368-1:2014(EU); EN 60825-1:2014 + A11:2021/IEC 60825-1:2014 (Class 1 Laser Product); EN 62479:2010/IEC 62479:2010; IEC 62471:2006 / EN 62471:2008; Low Voltage Directive 2014/35/EU with CE Mark (Europe); GS Certificate (Germany, Europe); UL/cUL Listed and UC CoC (US/Canada); UL62368-1 2nd Ed. 2014-12-01, CSA C22.2 No. 62368-1-14, 2nd Ed.; Compliance with Laser safety standards 21 CFR 1040.10 and 1040.11 except for deviations pursuant to Laser notice No. 56, Dated May 8, 2019; Other safety approvals as required by individual countries.			
ENERGY STAR Certified	Yes			
Ecolabels	CECP; IT ECO Declaration; Blue Angel; SEPA; EPEAT® Gold registered; KOECO			
Blue Angel compliance	Yes, Blue Angel DE-UZ 219—only ensured when using Original HP supplies			
Sustainable impact specifications	15% post-consumer recycled plastic; ENERGY STAR® certified; EPEAT® registered			
Network capabilities	Yes, via HP Jetdirect Ethernet embedded print server (standard) which supports: 10Base-T, 100Base-Tx, 1000Base-T; 802.3az (EEE) support on Fast Ethernet and Gig Links; IPsec (standard); 802.11a/b/g/n wireless networking (optional)			
Supported network protocols	Via built-in networking solution: TCP/IP, IPv4, IPv6; Print: TCP-IP port 9100 Direct Mode, LPD (raw queue support only), Web Services Printing, IPP 2.0, Apple AirPrint™, FTP Print, Google Cloud Print; Discovery: SLP, Bonjour, Web Services Discovery; IP Config: IPv4 (BootP, DHCP, AutoIP, Manual, TFTP Config, ARP-Ping), IPv6 (Stateless Link-Local and via Router, Statefull via DHCPv6); Management: SNMPv2/v3, HTTP/HTTPS, Telnet, TFTP Config, FTP FW Download, Syslog; Security: SNMPv3, SSL Cert Management, Firewall, ACL, 802.1x			
Mobile printing capability	Apple AirPrint™; Mopria™ certified; Wi-Fi® Direct printing; Google Cloud Print™; Wireless Direct printing			
Connectivity, Std	1 Bluetooth Low Energy; 1 Fax; 1 Front USB port; 1 Gigabit Ethernet 10/100/1000T network; 1 Hardware Integration Pocket 2 nd generation (HIP2); 1 SuperSpeed USB 3.0 (device); 1 SuperSpeed USB 3.0 (host); 1 Wi-Fi 802.11ac (dual band); 1 Wi-Fi Direct			
Copier reduce/enlarge	25 to 400%			
Max. number of copies	Up to 9,999 copies			
Copy resolution	Black text		Up to 600 x 600 dpi	
	Color, text, and graphics		Up to 600 x 600 dpi	
Copy speed	Black	A4	Up to 52 cpm; Up to 61 cpm (with 49K94AAE)	
		Letter	Up to 55 cpm; Up to 65 cpm (with 49K94AAE)	
	Color	A4	Up to 52 cpm; Up to 61 cpm (with 49K94AAE)	
		Letter	Up to 55 cpm; Up to 65 cpm (with 49K94AAE)	
Digital sending standard features	Scan to Email; Scan to Network Folder; Scan to USB Drive; Scan to SharePoint; Scan to FTP; Scan to SFTP; Scan to LAN Fax; Scan to Internet Fax; Local address book; SMTP over SSL; automatically detect color/monochrome; high compression PDF; image adjustments (darkness, contrast, background cleanup, sharpness); optimize text/picture (text, mixed, printed picture, photograph); content orientation; scan mode (book, 2-sided ID); erase edges; auto page crop; job build; image preview; blank page suppression; automatically straighten			
Package dimensions	Imperial	31.10 x 29.92 x 45.83 in	Metric	790 x 760 x 1164 mm
	Max. dimensions	Imperial	33.9 x 32.5 x 44.8 in	Metric

HP Color LaserJet Enterprise MFP X677s technical specifications

Product dimensions	Imperial	19.7 x 18.7 x 35.2 in	Metric	500 x 476 x 894 mm
Display description	8.0-in Color Graphic Display (CGD) with touchscreen; rotating (adjustable angle)			
Acoustic power emissions	Active, printing	6.6 B(A)		
Acoustic pressure emissions bystander	Ready	18 dB(A)		
Operating humidity range	10 to 80% RH			
Operating humidity range (recommended)	30 to 70% RH			
Operating temperature range	Celsius: 10 to 32.5°C	Recommended celsius: 15 to 27°C	Fahrenheit: 50 to 91°F	Recommended fahrenheit: 59 to 80.6°F
Storage temperature range	Celsius: -20 to 40°C		Fahrenheit: -4 to 104°F	
Fax	Optional			
Fax speed	Letter: 3 sec per page	Up to 33.6 kbps (with optional analog fax accessory)		
Memory	Standard: 6 GB	Maximum: 6 GB		
Print resolution technologies	HP ImageREt 4800, Fine Lines (1200 x 1200 dpi), Quickview (300 x 300 dpi)			
Print speed	A4 Black: Up to 52 ppm; Up to 61 ppm (with 49K94AAE)	Letter Black: Up to 55 ppm; Up to 65 ppm (with 49K94AAE)	A4 Color: Up to 52 ppm; Up to 61 ppm (with 49K94AAE)	Letter Color: Up to 55 ppm; Up to 65 ppm (with 49K94AAE)
	Up to 55 ppm (black) and 55 ppm (color); with optional speed license, print up to 65 ppm (black) and 65 ppm (color)			
First page out	Black	A4, ready	As fast as 6.6 sec; As fast as 6.6 sec (with 49K94AAE)	
		Letter, ready	As fast as 6.5 sec; As fast as 6.4 sec (with 49K94AAE)	
	Color	A4, ready	As fast as 7.4 sec; As fast as 7.1 sec (with 49K94AAE) Letter, ready	
Duty cycle	A4	Monthly	Up to 180,000 pages	
	Letter	Monthly	Up to 180,000 pages	
Recommended monthly page volume	Up to 30,000 pages			
Fonts and typefaces	105 internal TrueType fonts scalable in HP PCL, 92 internal scalable fonts in HP postscript level 3 emulation (Euro symbol built-in); 1 internal Unicode Fonts (Andale Mono WorldType); 2 Internal Windows Vista 8 fonts (Calibri, Cambria); additional font solutions available via third-party flash memory cards; HP LaserJet Fonts and IPDS Emulation available at https://www.hp.com/go/laserjetfonts			
Hard disk	Standard, minimum 500 GB HDD			
Print languages, standard	HP PCL 6, HP PCL 5, HP postscript level 3 emulation, native PDF printing (v 1.7), Apple AirPrint™			
Printer management	HP Web Jetadmin; Embedded Web Server; HP Security Manager; HP Insights; HP Advance; HP Command Center; HP Smart Device Services (SDS)			
Top key features	Automatic Document Feeder; Optional high-capacity trays; Touchscreen; TerraJet Cartridge			
Target number of users and print volume	For teams over 25 users; prints up to 30,000 pages/month			
Duplex print options	Automatic			
Print technology	Laser			
Paper trays, standard	2			
Input capacity	Standard: Up to 650 sheets			
Output capacity	Standard: Up to 1000 sheets			
Media type and capacity tray 1	Paper: 100 sheets of 75 g/m² media		Envelopes: 10	
Paper handling standard	Input: 550-sheet input tray, 100-sheet multi-purpose tray		Output: 500-sheet output tray, 500-sheet output stapler stacker	
Input capacity, Max. Envelopes	Up to 10 envelopes			
Product short name	X677			
Typical Electricity Consumption (TEC) number	0.849 kWh/week (ENERGY STAR 3.0); 0.810 kWh/week (Blue Angel)			
Number of simultaneous users (local + network)	10-30 users			
Scan resolution	Hardware: Up to 600 x 600 dpi		Optical: Up to 600 x 600 dpi	
	Enhanced: Up to 600 dpi			
Scan speed (normal, A4)	Up to 76 ppm/152 ipm (b&w), up to 76 ppm/152 ipm (color); Up to 76 ppm/152 ipm (b&w), up to 76 ppm/152 ipm (color) (with 49K94AAE)			
Automatic Document Feeder (ADF) capacity	Standard, 150 sheets			
Color scanning	Yes			
Grayscale levels	256			
Scan input modes	Front panel applications: Copy; E-Mail; FAX; Save to Network Folder; Save to USB; Save to Device Memory; Open Extensibility Platform (OXF) Applications, HP Workpath applications			

HP Color LaserJet Enterprise MFP X677s technical specifications

Scan size	Maximum	ADF, metric	216 x 864 mm	Minimum	ADF, metric	68 x 127 mm
		ADF, imperial	8.5 x 34.0 in		ADF, imperial	2.7 x 5.0 in
		Flatbed, metric	216 x 356 mm			
		Flatbed, imperial	8.5 x 14.0 in			
Bit depth	24-bit					
TWAIN Version	Version 2.4					
Security management	Identity management: Kerberos authentication; LDAP authentication; 1000 user pin codes; optional HP and 3 rd party advanced authentication solutions (e.g., badge readers); Network: IPsec/firewall with certificate; pre-shared key; Supports WJA-10 IPsec configuration Plug-in; 802.1X authentication (EAP-PEAP; EAP-TLS); SNMPv3; HTTPS; Certificates; Access Control List; Data: Storage Encryption; Encrypted PDF & Email (uses FIPS 140 validated cryptographic libraries from Microsoft); Secure Erase; SSL/TLS (HTTPS); Encrypted credentials; Device: Security lock slot; USB port disablement; Hardware Integration Pocket for security solutions; Intrusion Detection with Red Balloon Security Technology (Constant in-device monitoring for attacks); HP Sure Start Secure Boot (BIOS Integrity Checking with self-healing capability); Whitelisting (loads only known good code DLLs, EXEs, etc.); Security management: Compatible with Device Security Syslog Messages processed and accessible in Arcsight and Splunk SIEMs					
Mac compatible	Yes					
Software included	No software solutions are included in the box, only on: http://hp.com http://123.hp.com					
Media types	Paper (plain, light, intermediate, light bond, bond, recycled, mid-weight, heavy, mid-weight glossy, heavy glossy, extra heavy, extra heavy glossy, cardstock, card glossy), color transparency, labels, letterhead, envelope, pre-printed, pre-punched, colored, rough, opaque film, user-defined					
Standard media sizes supported	Metric	Tray 1: A4, A5, A6, RA4, B5, B6, 16k, 10 x 15 cm, Oficio, postcards (JIS single and double) envelopes (DL, C5, B5, C6); Tray 2, optional 1x550-sheet feeders: A4, A5, A6, RA4, B5, B6, 10 x 15 cm, Oficio, 16k, Dpostcard (JIS); optional 2,100-sheet high-capacity feeder: A4; A5 (with optional accessory)				
	Imperial	Tray 1: Letter, Legal, Executive, Statement, Oficio, 3 x 5 in, 4 x 6 in, 5 x 7 in, 5 x 8 in, envelopes (No. 9, No. 10, Monarch); Tray 2, optional 1x550-sheet feeders: Letter, Legal, Executive, Statement, Oficio, 4 x 6 in, 5 x 7 in, 5 x 8 in; optional 2,100-sheet high-capacity feeder: Letter, Legal; Statement (with optional accessory)				
Media size, tray 1	Metric	A4, A5, A6, RA4, B5, B6, 10 x 15 cm, Oficio 216 x 340, 16k, Postcard (JIS), DPostcard (JIS), Envelopes (DL, C5, B5, C6); custom 64 x 127 to 216 x 1200 mm				
Media sizes custom	Metric	Tray 1: 2.52 x 5 to 8.5 x 47.24 in; Tray 2, optional 1x550-sheet feeders: 4 x 5.83 to 8.5 x 14 in; optional 2,100-sheet high-capacity feeder: custom sizes not supported in this tray				
	Imperial	Tray 1: 2.52 x 5 to 8.5 x 47.24 in; Tray 2, optional 1x550-sheet feeders: 4 x 5.83 to 8.5 x 14 in; optional 2,100-sheet high-capacity feeder: custom sizes not supported in this tray				
Media weights supported	By paper path	Metric	Tray 1: 60 to 220 g/m ² (plain), 120 to 220 g/m ² (glossy); Tray 2: 60 to 220 g/m ² (plain), 120 to 220 g/m ² (glossy); optional 550-sheet input trays: 60 to 220 g/m ² (plain), 120 to 220 g/m ² (glossy); optional 2,100-sheet high-capacity input: 60 to 220 g/m ² (plain)			
		Imperial	Tray 1: 16 to 58 lb (plain), 32 to 58 lb (glossy); Tray 2: 16 to 58 lb (plain), 32 to 58 lb (glossy); optional 550-sheet input trays: 16 to 58 lb (plain), 32 to 58 lb (glossy); optional 2,100-sheet high-capacity input: 16 to 58 lb (plain)			
	ADF	Metric	45 to 199 g/m ²			
		Imperial	12 to 53 lb			
	Tray 1	Metric	60 to 220 g/m ² (plain), 120 to 220 g/m ² (glossy)			
Media size, ADF	Letter; legal; oficio; executive; statement; 16K; A4; RA4; A5; A6; B5; B6 (JIS); Postcard (JIS); DPostcard (JIS); 4 x 6 in; 5 x 7 in; 5 x 8 in; 68 x 147 mm to 215.9 x 863.6 mm; 2.68 x 5.79 in to 8.46 x 34 in					
Key media sizes supported	Metric	A4				
	Imperial	Letter; Legal				
Control panel	8.0-in touchscreen with color graphics					
System requirements, Macintosh, minimum	2 GB available hard drive space; Internet connection; or USB port; Internet browser; For additional OS hardware requirements, see apple.com					
System requirements, minimum	2 GB available hard disk space; Internet connection; or USB port; Internet browser; For additional OS hardware requirements, see microsoft.com					
Manufacturer warranty	One-year Next Business Day Onsite Warranty. Warranty and support options vary by product, country, and local legal requirements. Go to https://hp.com/support to learn about HP award-winning service and support options in your region.					
Weight	Metric	61.60 kg	Imperial	135.52 lb		
Package weight	Metric	~79.30 kg	Imperial	~174.46 lb		

HP Color LaserJet Enterprise Flow MFP X677z technical specifications

Processor speed	1.6 GHz					
Orderable supplies	W9270MC HP W9270MC Black Managed Original LaserJet Toner Cartridge (~44,000 pages); W9271MC HP W9271MC Cyan Managed Original LaserJet Toner Cartridge (~33,000 pages); W9272MC HP W9272MC Yellow Managed Original LaserJet Toner Cartridge (~33,000 pages); W9273MC HP W9273MC Magenta Managed Original LaserJet Toner Cartridge (~33,000 pages); HP W9280MC Black Managed Original LaserJet Imaging Drum (~150,000 pages); HP W9281MC Cyan Managed Original LaserJet Imaging Drum (~150,000 pages); HP W9282MC Yellow Managed Original LaserJet Imaging Drum (~150,000 pages); HP W9283MC Magenta Managed Original LaserJet Imaging Drum (~150,000 pages); HP LaserJet 110V Enhanced Fuser Kit 527G2A; HP LaserJet 220V Enhanced Fuser Kit 527G3A; HP LaserJet Managed 110V Enhanced Fuser Kit 527G4MC; HP LaserJet Managed 220V Enhanced Fuser Kit 527G5MC; HP LaserJet Managed Image Transfer Belt Kit 527H0MC; HP LaserJet Managed Transfer Roller Kit 527H1MC; HP LaserJet Tray 2 Roller Kit 527H2A; HP LaserJet MP Tray Roller Kit 527H3A; HP LaserJet ADF Maintenance Kit 6H122A; HP LaserJet ADF Flow Maintenance Kit 6M1P3A; HP LaserJet Toner Collection Unit 527F9A; HP Staple Cartridge Refill (5,000 staples) J8J96					
Printer smart software features	Apple AirPrint™, Mopria-certified, Open Extensibility Platform, FutureSmart firmware, Instant-on Technology, HP Auto-On/Auto-Off technology, Easy-access USB, Two-sided printing, Hardware Integration Pocket, intuitive 10.1-in touchscreen control panel, print multiple pages per sheet (2, 4, 6, 9, 16), collation, watermarks, store print jobs, print preview					
Power consumption description	816 watts (printing/copying), 63.4 watts (Ready), 11 watts (Sleep), 0.1 watts (Auto off/Manual on), 0.1 watts (Manual off)					
Power supply type	Built in 110V or 220V power supply (not dual voltage, power supply varies by part number with option code identifier)					
Power supply required	Input voltage: 100V to 127V nominal (+/-10%), 50 - 60 Hz nominal (+/- 3 Hz), 12A; Input voltage: 220V to 240V nominal, (+/-10%) 50 - 60 Hz nominal (+/- 3 Hz), 6A					
What's in the box	HP Color LaserJet Multifunction printer; HP Black Original LaserJet Toner cartridge (~9,000 yield), HP Cyan, Magenta, and Yellow Original LaserJet Toner cartridges (~5,000 yield each) (Toner cartridges installed); Documentation (Hardware Installation guide); Power cord; Tray Lock Kit (Paper-size cassette locks, paper tray interface screws, P-cartridge door access control screws)					
Supplies feature	TerraJet Cartridge					
Electromagnetic emission standard	CISPR 22:2008 (International) Class A, CISPR 32:2015 (International) Class A / EN 55032:2015 Class A + A1:2020, CISPR 35:2016 (International) / EN 55035:2017 + A1:2020, EN IEC 61000-3-2:2019, EN 61000-3-3:2013+A1:2019 + A2:2021, FCC 47 CFR Part 15 Class A, ICES-003, Issue 7 Class A. Other EMC approvals as required by individual countries.					
Safety approvals and requirements	IEC 60950-1:2005 +A1:2009 +A2:2013 (International); IEC 62368-1:2014; EN 62368-1:2014(EU); EN 60825-1:2014 +A1:2021/IEC 60825-1:2014 (Class 1 Laser Product); EN 62479:2010/IEC 62479:2010; IEC 62471:2006 / EN 62471:2008; Low Voltage Directive 2014/35/EU with CE Mark (Europe); GS Certificate (Germany, Europe); UL/cUL Listed and UC CoC (US/Canada); UL62368-1 2nd Ed. 2014-12-01, CSA C22.2 No. 62368-1:14, 2nd Ed.; Compliance with Laser safety standards 21 CFR 1040.10 and 1040.11 except for deviations pursuant to Laser notice No. 56, dated May 8, 2019; Other safety approvals as required by individual countries.					
ENERGY STAR® certified	Yes					
Ecolabels	CECP; IT ECO Declaration; Blue Angel; EPEAT® Gold registered; SEPA; KOECO					
Blue Angel compliance	Yes, Blue Angel DE-UZ 219—only ensured when using Original HP supplies					
Sustainable impact specifications	15% post-consumer recycled plastic; ENERGY STAR® certified; EPEAT® registered					
Network capabilities	Yes, via HP Jetdirect Ethernet embedded print server (standard) which supports: 10Base-T, 100Base-Tx, 1000Base-T; 802.3az (EEE) support on Fast Ethernet and Gig Links; IPsec (standard); 802.11a/b/g/n wireless networking (optional)					
Supported network protocols	Via built-in networking solution: TCP/IP, IPv4, IPv6; Print: TCP-IP port 9100 Direct Mode, LPD (raw queue support only), Web Services printing, IPP 2.0, Apple AirPrint™, FTP Print, Google Cloud print; Discovery: SLP, Bonjour, Web Services Discovery; IP Config: IPv4 (BootP, DHCP, AutoIP, Manual, TFTP Config, ARP-Ping), IPv6 (Stateless Link-Local and via Router, Statefull via DHCPv6); Management: SNMPv2/v3, HTTP/HTTPS, Telnet, TFTP Config, FTP FW Download, Syslog; Security: SNMPv3, SSL Cert Management, Firewall, ACL, 802.1x					
Mobile printing capability	Apple AirPrint™; Mopria™ Certified; NFC touch-to-print (optional)					
Connectivity, std.	1 SuperSpeed USB 3.0 (device); 1 SuperSpeed USB 3.0 (host); 1 Hi-Speed USB 2.0 (host); 1 Gigabit Ethernet 10/100/1000T network; 1 Hardware Integration Pocket 2 nd generation (HIP2)					
Copier reduce/enlarge	25 to 400%					
Max. number of copies	Up to 9,999 copies					
Copy resolution	Black text		Up to 600 x 600 dpi			
	Color, text, and graphics		Up to 600 x 600 dpi			
Copy speed	Black	A4	Up to 52 cpm; Up to 61 cpm (with 49K94AAE)			
		Letter	Up to 55 cpm; Up to 65 cpm (with 49K94AAE)			
	Color	A4	Up to 52 cpm; Up to 61 cpm (with 49K94AAE)			
		Letter	Up to 55 cpm; Up to 65 cpm (with 49K94AAE)			
Digital sending standard features	Scan to Email; Scan to Network Folder; Scan to USB drive; Scan to SharePoint; Scan to FTP; scan to SFTP; scan to LAN Fax; Scan to Internet Fax; Local address book; SMTP over SSL; automatically detect color/monochrome; high compression PDF; image adjustments (darkness, contrast, background cleanup, sharpness); optimize text/picture (text, mixed, printed picture, photograph); content orientation; scan mode (book, 2-sided ID); erase edges; auto page crop; job build; image preview; blank page suppression; automatically straighten; embedded OCR; optimize text/picture (auto); scan to multi-destination; automatic tone; auto orientation; multi-feed detection; Reverse and Retry; document editing; auto paper color removal; job separation (blank page, barcode); watermark; stamps					
Package dimensions	Imperial	31.10 x 29.92 x 45.83 in		Metric	790 x 760 x 1164 mm	
Max. dimensions	Imperial	33.9 x 32.5 x 44.8 in		Metric	860 x 826 x 1139 mm	

HP Color LaserJet Enterprise Flow MFP X677z technical specifications

Product dimensions	Imperial	19.7 x 18.7 x 35.2 in	Metric	500 x 476 x 894 mm
Display description	101-in Color Graphic Display (CGD) with touchscreen; rotating (adjustable angle)			
Acoustic power emissions	Active, printing	6.6 B(A)		
Acoustic pressure emissions bystander	Ready	18 dB(A)		
Operating humidity range	10 to 80% RH			
Operating humidity range (recommended)	30 to 70% RH			
Operating temperature range	Celsius: 10 to 32.5°C	Recommended celsius: 15 to 27°C	Fahrenheit: 50 to 91°F	Recommended fahrenheit: 59 to 80.6°F
Storage temperature range	Celsius: -20 to 40°C		Fahrenheit: -4 to 104°F	
Fax	Optional			
Fax speed	Letter: 3 sec per page	Up to 33.6 kbps (with optional analog fax accessory)		
Memory	Standard: 6 GB	Maximum: 6 GB		
Print resolution technologies	HP ImageREt 4800, Fine Lines (1200x1200 dpi), Quickview (300x300 dpi)			
Print speed	A4 Black: Up to 52 ppm; Up to 61 ppm (with 49K94AAE)	Letter Black: Up to 55 ppm; Up to 65 ppm (with 49K94AAE)	A4 Color: Up to 52 ppm; Up to 61 ppm (with 49K94AAE)	Letter Color: Up to 55 ppm; Up to 65 ppm (with 49K94AAE)
	Print speeds up to 55 ppm (black) and 65 ppm (color); with optional speed license, print up to 65 ppm (black and 65 ppm (color)			
First page out	Black	A4, ready	As fast as 6.6 sec; As fast as 6.5 sec (with 49K94AAE)	
		Letter, ready	As fast as 6.5 sec; As fast as 6.4 sec (with 49K94AAE)	
	Color	A4, ready	As fast as 7.4 sec; As fast as 7.1 sec (with 49K94AAE)	
		Letter, ready	As fast as 7.3 sec; As fast as 6.9 sec (with 49K94AAE)	
Duty cycle	A4	Monthly	Up to 180,000 pages	
	Letter	Monthly	Up to 180,000 pages	
Recommended monthly page volume	Up to 30,000 pages			
Fonts and typefaces	105 internal TrueType fonts scalable in HP PCL, 92 internal scalable fonts in HP postscript level 3 emulation (Euro symbol built-in); 1 internal Unicode fonts (Andale Mono World Type); 2 internal Windows Vista 8 fonts (Calibri, Cambria); additional font solutions available via third-party flash memory cards; HP LaserJet Fonts and IPDS Emulation available at https://www.hp.com/go/laserjetfonts			
Hard disk	Standard, minimum 500 GB HDD			
Print languages, standard	HP PCL 6, HP PCL 5, HP postscript level 3 emulation, native PDF printing (v 1.7), Apple AirPrint™			
Printer management	HP Web Jetadmin; Embedded Web Server; HP Security Manager; HP Insights; HP Advance; HP Command Center; HP Smart Device Services (SDS)			
Top key features	Flow, Touchscreen; Stapling; TerraJet Cartridge			
Target number of users and print volume	For teams over 25 users; Prints up to 30,000 pages/month			
AIO Functions	Print, copy, scan, fax (optional)			
Duplex print options	Automatic			
Print technology	Laser			
Paper trays, standard	2			
Input capacity	Standard: Up to 650 sheets			
Output capacity	Standard: Up to 1,000 sheets			
Media type and capacity tray 1	Paper: 100 sheets of 75 g/m² media		Envelopes: 10	
Paper handling standard	Input: 550-sheet input tray, 100-sheet multi-purpose tray		Output: 500-sheet output tray, 500-sheet output stapler stacker	
Input capacity, max. envelopes	Up to 10 envelopes			
Product short name	X677			
Typical Electricity Consumption (TEC) number	0.849 kWh/week (ENERGY STAR 3.0); 0.810 kWh/week (Blue Angel)			
Number of simultaneous users (local + network)	Over 25 Users			
Scan resolution	Hardware: Up to 600 x 600 dpi		Optical: Up to 600 x 600 dpi Enhanced: Up to 600 dpi	
Scan speed (normal, A4)	Up to 95 ppm/190 ipm (b&w), up to 95 ppm/190 ipm (color); Up to 95 ppm/190 ipm (b&w), up to 95 ppm/190 ipm (color) (with 49K94AAE)			
Automatic Document Feeder (ADF) capacity	Standard, 150 sheets			
Color scanning	Yes			
Grayscale levels	256			
Scan input modes	Front Panel applications: Copy; E-Mail; FAX; Save to Network Folder; Save to USB; Save to Device Memory; Open Extensibility Platform (OXF) applications, HP Workpath applications			

HP Color LaserJet Enterprise Flow MFP X677z technical specifications

Scan size	Maximum	ADF, metric	216 x 864 mm	Minimum	ADF, metric	68 x 127 mm
		ADF, imperial	8.5 x 34.0 in		ADF, imperial	2.7 x 5.0 in
		Flatbed, metric	216 x 356 mm			
		Flatbed, imperial	8.5 x 14.0 in			
Bit depth	24-bit					
TWAIN Version	Version 2.4					
Security management	Identity management: Kerberos authentication; LDAP authentication; 1000 user pin codes; optional HP and 3 rd party advanced authentication solutions (e.g., badge readers); Network: IPsec/firewall with certificate; pre-shared key; Supports WJA-10 IPsec configuration Plug-in; 802.1X authentication (EAP-PEAP, EAP-TLS); SNMPv3; HTTPS; Certificates; Access Control List; Data: Storage Encryption; Encrypted PDF & Email (uses FIPS 140 validated cryptographic libraries from Microsoft); Secure Erase; SSL/TLS (HTTPS); Encrypted credentials; Device: Security lock slot; USB port disablement; Hardware Integration Pocket for security solutions; Intrusion Detection with Red Balloon Security technology (Constant in-device monitoring for attacks); HP Sure Start Secure Boot (BIOS Integrity Checking with self-healing capability); Whitelisting (loads only known good code DLLs, EXEs, etc.); Security management: Compatible with Device Security Syslog Messages processed and accessible in Arcsight and Splunk SIEMs					
Mac compatible	Yes					
Software included	No software solutions are included in the box, only on: http://hp.com http://123.hp.com					
Media types	Paper (plain, light, intermediate, light bond, bond, recycled, mid-weight, heavy, mid-weight glossy, heavy glossy, extra heavy, extra heavy glossy, cardstock, card glossy), color transparency, labels, letterhead, envelope, preprinted, prepunched, colored, rough, opaque film, user-defined					
Standard media sizes supported	Metric	Tray 1: A4, A5, A6, RA4, B5, B6, 16k, 10 x 15 cm, Oficio, postcards (JIS single and double) envelopes (DL, C5, B5, C6); Tray 2, optional 1x550-sheet feeders: A4, A5, A6, RA4, B5, B6, 10 x 15 cm, Oficio, 16k, Dpostcard (JIS); optional 2,100-sheet high-capacity feeder: A4; A5 (with optional accessory)				
	Imperial	Tray 1: Letter, Legal, Executive, Statement, Oficio, 3 x 5 in, 4 x 6 in, 5 x 7 in, 5 x 8 in, envelopes (No. 9, No. 10, Monarch); Tray 2, optional 1x550-sheet feeders: Letter, Legal, Executive, Statement, Oficio, 4 x 6 in, 5 x 7 in, 5 x 8 in; optional 2,100-sheet high-capacity feeder: Letter, lLegal; Statement (with optional accessory)				
Media sizes custom	Metric	Tray 1: 2.52 x 5 to 8.5 x 47.24 in; Tray 2, optional 1x550-sheet feeders: 4 x 5.83 to 8.5 x 14 in; optional 2,100-sheet high-capacity feeder: custom sizes not supported in this tray				
	Imperial	A4, A5, A6, RA4, B5, B6, 10 x 15 cm, Oficio 216 x 340, 16k, Postcard (JIS), DPostcard (JIS), Envelopes (DL, C5, B5, C6); custom 64 x 127 to 216 x 1200 mm				
Media weights supported	By paper path	Metric	Tray 1: 60 to 220 g/m ² (plain), 120 to 220 g/m ² (glossy); Tray 2: 60 to 220 g/m ² (plain), 120 to 220 g/m ² (glossy); optional 550-sheet input trays: 60 to 220 g/m ² (plain), 120 to 220 g/m ² (glossy); optional 2,100-sheet high-capacity input: 60 to 220 g/m ² (plain)			
		Imperial	Paper (plain, light, intermediate, light bond, bond, recycled, mid-weight, heavy, mid-weight glossy, heavy glossy, extra heavy, extra heavy glossy, cardstock, card glossy), color transparency, labels, letterhead, envelope, pre-printed, pre-punched, colored, rough, opaque film, user-defined			
	ADF	Metric	45 to 199 g/m ²			
		Imperial	12 to 53 lb			
	Tray 1	Metric	60 to 220 g/m ² (plain), 120 to 220 g/m ² (glossy)			
Media size, ADF	Letter; Legal; Oficio; Executive; Statement; 16K; A4; RA4; A5; A6; B5; B6 (JIS); Postcard (JIS); DPostcard (JIS); 4 x 6 in; 5 x 7 in; 5 x 8 in; 68 x 147 mm to 215.9 x 863.6 mm; 2.68 x 5.79 in to 8.46 x 34 in					
Key media sizes supported	Metric	A4				
	Imperial	Letter; Legal				
Control panel	10.1-in touchscreen with color graphics					
System requirements, Macintosh, minimum	2 GB available hard drive space; Internet connection; or USB port; Internet browser. For additional OS hardware requirements, see apple.com					
System requirements, minimum	2 GB available hard disk space; Internet connection; or USB port; Internet browser. For additional OS hardware requirements, see microsoft.com					
Manufacturer warranty	One-year Next Business Day Onsite Warranty. Warranty and support options vary by product, country, and local legal requirements. Go to http://hp.com/support to learn about HP award-winning service and support options in your region.					
Weight	Metric	61.6 kg	Imperial	135.52 lb		
Package weight	Metric	~79.3 kg	Imperial	174.46 lb		

HP Color LaserJet Enterprise Flow MFP X677z+ technical specifications

Processor speed	1.6 GHz					
Orderable supplies	HP W9270MC Black Managed Original LaserJet Toner Cartridge (~44,000 pages); HP W9271MC Cyan Managed Original LaserJet Toner Cartridge (~33,000 pages); HP W9272MC Yellow Managed Original LaserJet Toner Cartridge (~33,000 pages); HP W9273MC Magenta Managed Original LaserJet Toner Cartridge (~33,000 pages); HP W9280MC Black Managed Original LaserJet Imaging Drum (~150,000 pages); HP W9281MC Cyan Managed Original LaserJet Imaging Drum (~150,000 pages); HP W9282MC Yellow Managed Original LaserJet Imaging Drum (~150,000 pages); HP W9283MC Magenta Managed Original LaserJet Imaging Drum (~150,000 pages); HP LaserJet 110V Enhanced Fuser Kit 527G2A; HP LaserJet 220V Enhanced Fuser Kit 527G3A; HP LaserJet Managed 110V Enhanced Fuser Kit 527G4MC; HP LaserJet Managed 220V Enhanced Fuser Kit 527G5MC; HP LaserJet Managed Image Transfer Belt Kit 527H0MC; HP LaserJet Managed Transfer Roller Kit 527H1MC; HP LaserJet Tray 2 Roller Kit 527H2A; HP LaserJet MP Tray Roller Kit 527H3A; HP LaserJet ADF Maintenance Kit 6H122A; HP LaserJet ADF Flow Maintenance Kit 6M1P3A; HP LaserJet Toner Collection Unit 527F9A; HP Staple Cartridge Pack (3,000 staples) Q7432A; HP Staple Cartridge Refill (5,000 staples) J8J96A ¹³					
Printer smart software features	Print preview, duplex printing, print multiple pages per sheet (2, 4, 6, 9, 16), collation, watermarks, store print jobs, easy-access USB, HP EasyColor					
Power consumption description	816 watts (Printing/Copying), 63.4 watts (Ready), 1.1 watts (Sleep), 0.1 watts (Auto Off/Manual On), 0.1 watts (Manual Off)					
Power supply type	Built in 110V or 220V power supply (not dual voltage, power supply varies by part number with option code identifier)					
Power supply required	Input voltage: 100V to 127V nominal (+/-10%), 50 - 60 Hz nominal (+/- 3 Hz), 12 A; Input voltage: 220 V to 240V nominal, (+/-10%) 50 - 60 Hz nominal (+/- 3 Hz), 6A					
What's in the box	HP Color LaserJet Multifunction Printer; HP Black Original LaserJet Toner Cartridge (~9,000 yield), HP Cyan, Magenta and Yellow Original LaserJet Toner Cartridges (~5,000 yield each) (toner cartridges installed); Documentation (Hardware Installation guide); Power cord; Tray Lock Kit (Paper-size cassette locks, paper tray interface screws, P-cartridge door access control screws)					
Supplies feature	TerraJet Cartridge					
Electromagnetic emission standard	CISPR 22:2008 (International) Class A, CISPR 32:2015 (International) Class A / EN 55032:2015 Class A + A1:2020, CISPR 35:2016 (International) / EN 55035:2017 + A1:2020, EN IEC 61000-3-2:2019, EN 61000-3-3:2013+A1:2019 + A2:2021, FCC 47 CFR Part 15 Class A, ICES-003, Issue 7 Class A. Other EMC approvals as required by individual countries.					
Safety approvals and requirements	IEC 60950-1:2005 +A1:2009 +A2:2013 (International); IEC 62368-1:2014; EN 62368-1:2014 (EU); EN 60825-1:2014 +A1:2021/IEC 60825-1:2014 (Class 1 Laser Product); EN 62479:2010/IEC 62479:2010; IEC 62471:2006 / EN 62471:2008; Low Voltage Directive 2014/35/EU with CE Mark (Europe); GS certificate (Germany, Europe); UL/cUL Listed and UC CoC (US/Canada); UL62368-1 2nd Ed. 2014-12-01, CSA C22.2 No. 62368-1:14, 2nd Ed.; Compliance with laser safety standards 21 CFR 1040.10 and 1040.11 except for deviations pursuant to laser Notice No. 56, Dated May 8, 2019; Other safety approvals as required by individual countries.					
ENERGY STAR® certified	Yes					
Ecolabels	CECP; IT ECO Declaration; Blue Angel; SEPA; EPEAT® Gold registered; KOECO					
Blue Angel compliance	Yes, Blue Angel DE-UZ 219—only ensured when using Original HP supplies					
Sustainable impact specifications	15% post-consumer recycled plastic; ENERGY STAR® certified; EPEAT® registered					
Network capabilities	Yes, via HP Jetdirect Ethernet embedded print server (standard) which supports: 10Base-T, 100Base-Tx, 1000Base-T; 802.3az (EEE) support on Fast Ethernet and Gig Links; IPsec (standard); 802.11a/b/g/n wireless networking (optional)					
Supported network protocols	Via built-in networking solution: TCP/IP, IPv4, IPv6; Print: TCP-IP port 9100 Direct Mode, LPD (raw queue support only), Web Services printing, IPP 2.0, Apple AirPrint™, FTP Print, Google Cloud Print, Discovery; SLP, Bonjour, Web Services Discovery; IP Config: IPv4 (BootP, DHCP, AutoIP, Manual, TFTP Config, ARP-Ping), IPv6 (Stateless Link-Local and via Router, Stateful via DHCPv6); Management: SNMPv2/v3, HTTP/HTTPS, Telnet, TFTP Config, FTP FW Download, Syslog; Security: SNMPv3, SSL Cert Management, Firewall, ACL, 802.1x					
Mobile printing capability	Apple AirPrint™; Mopria™ certified					
Copier reduce/enlarge	25 to 400%					
Max. number of copies	Up to 9,999					
Copy resolution	Black text	Up to 600 x 600 dpi				
	Color, text, and graphics	Up to 600 x 600 dpi				
Copy speed	Black	A4	Up to 52 cpm; Up to 61 cpm (with 49K94AAE)			
		Letter	Up to 55 cpm; Up to 65 cpm (with 49K94AAE)			
	Color	A4	Up to 52 cpm; Up to 61 cpm (with 49K94AAE)			
		Letter	Up to 55 cpm; Up to 65 cpm (with 49K94AAE)			
Digital sending standard features	Scan to E-mail; Save-to-Network Folder; Save-to-USB drive; Send to Sharepoint; Send to FTP; Send to SFTP; Send to LAN Fax; Send to Internet Fax; local address book; SMTP over SSL; auto color sense; compact PDF; image adjustments (darkness, contrast, background cleanup, sharpness); optimized text/picture (auto, text, mixed, printed picture, photograph); content orientation; ID scan; job build; watermark; stamps; book mode scans; erase edges; image preview; blank page suppression; scan to multi-destination; embedded OCR; auto-tone, auto orientation, auto-page-crop; multi-feed detection; Reverse and Retry; document editing; auto paper color removal; job separation; automatically straighten					
Package dimensions	Imperial	31.10 x 29.92 x 57.44 in		Metric	790 x 760 x 1459 mm	
Max. dimensions	Imperial	61.1 x 37.0 x 59.2 in		Metric	1552 x 939 x 1503 mm	
Product dimensions	Imperial	47.3 x 22.0 x 49.9 in		Metric	1202 x 559 x 1267 mm	
Display description	10.1-in Color Graphics Display (CGD) with touchscreen; rotating (adjustable angle) display					
Acoustic power emissions	Active, printing	6.7 B(A)				
Acoustic pressure emissions bystander	Ready	19 dB(A)				
Operating humidity range	10 to 80% RH					
Operating humidity range (recommended)	30 to 70% RH					
Operating temperature range	Celsius: 10 to 32.5°C	Recommended celsius: 15 to 27°C		Fahrenheit: 50 to 91°F	Recommended fahrenheit: 59 to 80.6°F	
Storage temperature range	Celsius: -20 to 40°C			Fahrenheit: -4 to 104°F		
Fax	Optional					

HP Color LaserJet Enterprise Flow MFP X677z+ technical specifications

Fax speed	3 sec per page	Up to 33.6 kbps						
Memory	Standard: 6 GB	Maximum: 6 GB						
Print resolution technologies	HP ImageREt 4800, Fine Lines (1200 x 1200 dpi), Quickview (300 x 300 dpi)							
Print resolution color (best)	Up to 1200 x 1200 dpi							
Print speed	A4 Black: Up to 52 ppm; Up to 61 ppm (with 49K94AAE)	Letter Black: Up to 55 ppm; Up to 65 ppm (with 49K94AAE)		A4 Color: Up to 52 ppm; Up to 61 ppm (with 49K94AAE)	Letter Color: Up to 55 ppm; Up to 65 ppm (with 49K94AAE)			
	Up to 55 ppm (black) and 55 ppm (color); with optional speed license, print up to 65 ppm (black) and 65 ppm (color)							
First page out	Black	A4, ready		As fast as 8.8 sec; As fast as 7.9 sec (with 49K94AAE)				
		Letter, ready		As fast as 8.7 sec; As fast as 7.8 sec (with 49K94AAE)				
	Color	A4, ready		As fast as 9.2 sec; As fast as 8.7 sec (with 49K94AAE)				
		Letter, ready		As fast as 9.1 sec; As fast as 8.6 sec (with 49K94AAE)				
Duty cycle	A4	Monthly		Up to 180,000 pages				
	Letter	Monthly		Up to 180,000 pages				
Recommended monthly page volume	Up to 30,000 pages							
Fonts and typefaces	105 internal TrueType fonts scalable in HP PCL, 92 internal scalable fonts in HP postscript level 3 emulation (Euro symbol built-in); 1 internal Unicode Fonts (Andale Mono World Type); 2 internal Windows Vista 8 fonts (Calibri, Cambria); additional font solutions available via third-party flash memory cards; HP LaserJet Fonts and IPDS Emulation available at https://www.hp.com/go/laserjetfonts							
Hard disk	Standard, minimum 500 GB HDD; Optional, 256 GB SSD							
Print languages, standard	HP PCL 6, HP PCL 5, HP postscript level 3 emulation, native PDF printing (v 1.7), Apple AirPrint™							
Printer management	HP Web Jetadmin; Embedded Web Server; HP Security Manager; HP Insights; HP Advance; HP Command Center; HP Smart Device Services (SDS)							
Top key features	Flow; Touchscreen; Stapling; TerraJet cartridge							
Target number of users and print volume	For teams over 25 users; prints up to 30,000 pages/month							
AIO Functions	Print, copy, scan, fax (optional)							
Duplex print options	Automatic							
Print technology	Laser							
Paper trays, standard	5							
Input capacity	Standard: Up to 3,300 sheets							
Output capacity	Standard: Up to 3,300 sheets							
Media type and capacity tray 1	Paper: 100 sheets of 75 g/m ² media			Envelopes: 10				
Paper handling standard	Input: 100-sheet multi-purpose tray, 2x550-sheet input trays, 2,100-sheet high capacity input			Output: Staple; Stack; Job Offset; Punch; Booklet Staple				
Product short name	X677							
Typical Electricity Consumption (TEC) number	0.849 kWh/week (ENERGY STAR 3.0); 0.810 kWh/week (Blue Angel)							
Number of simultaneous users (local + network)	10-30 users							
Scan resolution	Hardware: Up to 600 x 600 dpi		Optical: Up to 600 dpi		Enhanced: Up to 600 dpi			
Scan speed (normal, A4)	Up to 95 ppm/190 ipm (b&w), up to 95 ppm/190 ipm (color); Up to 95 ppm/190 ipm (b&w), up to 95 ppm/190 ipm (color) (with 49K94AAE)							
Automatic Document Feeder (ADF) capacity	Standard, 150 sheets							
Color scanning	Yes							
Grayscale levels	256							
Scan input modes	Front panel applications: Copy; Fax; Scan to Email; Scan to Network Folder; Scan to USB; Scan to Job Storage; Open Extensibility Platform (OXF), HP Workpath applications							
Scan size	Maximum	ADF, metric	215.9 x 863.6 mm		Minimum	ADF, metric	68 x 127 mm	
		ADF, imperial	8.5 x 34.0 in			ADF, imperial	2.7 x 5.0 in	
	Flatbed, metric	216 x 356 mm						
		Flatbed, imperial	8.5 x 14.0 in					
Bit depth	24-bit							
TWAIN Version	Version 2.4							

HP Color LaserJet Enterprise Flow MFP X677z+ technical specifications

Security management	Identity management: Kerberos authentication; LDAP authentication; 1,000 user pin codes; optional HP and 3 rd party advanced authentication solutions (e.g. badge readers); Network: IPsec/firewall with certificate; pre-shared Key; Supports WJA-10 IPsec configuration Plug-in; 802.1x authentication (EAP-PEAP; EAP-TLS); SNMPv3; HTTPS; Certificates; Access Control List; Data: Storage Encryption; Encrypted PDF & Email (uses FIPS 140 validated cryptographic libraries from Microsoft); Secure Erase; SSL/TLS (HTTPS); Encrypted Credentials; Device: Security lock slot; USB port disablement; Hardware Integration Pocket for security solutions; Intrusion Detection with Red Balloon Security technology - Constant in-device monitoring for attacks; Sure Start Secure Boot - BIOS Integrity Checking with self-healing capability; Whitelisting - loads only known good code (DLLs, ExEs, ...); Security management: Compatible with Device Security Syslog Messages processed and accessible in ArcSight and Splunk SIEMs			
Mac compatible	Yes			
Software included	No software solutions are included in the box, only on http://hp.com http://123.hp.com			
Media types	Paper (plain, light, intermediate, light bond, bond, recycled, mid-weight, heavy, mid-weight glossy, heavy glossy, extra heavy, extra heavy glossy, cardstock, card glossy), color transparency, labels, letterhead, envelope, pre-printed, pre-punched, colored, rough, opaque film, user-defined			
Standard media sizes supported	Metric	Tray 1: A4, A5, A6, RA4, B5, B6, 16k, 10 x 15 cm, Oficio, postcards (JIS single and double) envelopes (DL, C5, B5, C6); Tray 2, Tray 3 (1x550-sheet feeder): A4, A5, A6, RA4, B5, B6, 10 x 15 cm, Oficio, 16k, Dpostcard (JIS); Tray 4 (2,100-sheet high-capacity feeder): A4; A5 (with optional accessory)		
	Imperial	Tray 1: Letter, Legal, Executive, Statement, Oficio, 3 x 5 in, 4 x 6 in, 5 x 7 in, 5 x 8 in, envelopes (No. 9, No. 10, Monarch); Tray 2, Tray 3 (1x550-sheet feeder): Letter, Legal, Executive, Statement, Oficio, 4 x 6 in, 5 x 7 in, 5 x 8 in; Tray 4 (2,100-sheet high-capacity feeder): letter, legal; statement (with optional accessory)		
Media sizes custom	Metric	Tray 1: 64 x 127 to 216 x 356 mm; Tray 2, Tray 3 (1x550-sheet feeder): 101 x 148 to 216 x 356 mm; Tray 4 (2,100-sheet high-capacity feeder): custom sizes not supported in this tray		
	Imperial	Tray 1: 2.52 x 5 to 8.5 x 14 in; Tray 2, Tray 3 (1x550-sheet feeder): 4 x 5.83 to 8.5 x 14 in; Tray 4 (2,100-sheet high-capacity feeder): custom sizes not supported in this tray		
Media size, tray 1	Metric	A4, A5, A6, RA4, B5, B6, 10 x 15 cm, Oficio 216 x 340, 16k, Postcard (JIS), DPostcard (JIS), Envelopes (DL, C5, B5, C6); custom 64 x 127 to 216 x 356 mm		
Media weights supported	By paper path	Metric	Tray 1: 60 to 220 g/m ² (plain), 120 to 220 g/m ² (glossy); Tray 2: 60 to 220 g/m ² (plain), 120 to 220 g/m ² (glossy); optional 550-sheet input trays: 60 to 220 g/m ² (plain), 120 to 220 g/m ² (glossy); optional 2,100-sheet high-capacity input: 60 to 220 g/m ² (plain)	
		Imperial	Tray 1: 16 to 58 lb (plain), 32 to 58 lb (glossy); Tray 2: 16 to 58 lb (plain), 32 to 58 lb (glossy); optional 550-sheet input trays: 16 to 58 lb (plain), 32 to 58 lb (glossy); optional 2,100-sheet high-capacity input: 16 to 58 lb (plain)	
	ADF	Metric	45 to 199 g/m ²	
		Imperial	12 to 53 lb	
Tray 1	Metric	60 to 220 g/m ² (plain), 120 to 220 g/m ² (glossy)		
Media size, ADF	Letter; Legal; Oficio; Executive; Statement; 16K; A4; RA4; A5; A6; B5; B6 (JIS); Postcard (JIS); DPostcard (JIS); 4 x 6 in; 5 x 7 in; 5 x 8 in; 68 x 147 mm to 215.9 x 863.6 mm; 2.68 x 5.79 in to 8.46 x 34 in			
Key media sizes supported	Metric	A4		
	Imperial	Letter; Legal		
Control panel	10.1-in Color Graphics Display (CGD) with touchscreen; rotating (adjustable angle) display			
System requirements, Macintosh, minimum	2 GB available hard drive space; Internet connection; or USB port; Internet browser; For additional OS hardware requirements, see apple.com			
System requirements, minimum	2 GB available hard disk space; Internet connection; or USB port; Internet browser; For additional OS hardware requirements, see microsoft.com			
Manufacturer warranty	One-year Next Business Day Onsite Warranty. Warranty and support options vary by product, country, and local legal requirements. Go to http://hp.com/support to learn about HP award-winning service and support options in your region.			
Weight	Metric	8715 kg	Imperial	191.73 lb
Package weight	Metric	98.05 kg	Imperial	215.71 lb

X677 accessories

Accessory description	Accessory SKU #
HP Accessibility Kit	2TD64A
HP Internal USB Expansion Kit	4XN67A
HP Jetdirect LAN Accessory	8FP31A
HP Foreign Interface Harness	B5L31A
HP LaserJet Keyboard Overlay Kit for Simplified Chinese & Traditional Chinese (only compatible with Flow models)	A7W12A
HP LaserJet Keyboard Overlay Kit-Danish/French-Switzerland/German-Switzerland (only compatible with Flow models)	A7W13A
HP LaserJet Swedish Overlay Keyboard (only compatible with Flow models)	A7W14A
HP SmartCard NIPRNet Solution for US Government	CC543B
HP SmartCard SIPRNet Solution for US Government	F8B30A
HP Removable Hard Drive Enclosure	2NR12A
HP Printing Voice Assistant	478C2A
HP MFP Analog Fax 702 Accessory	1M0Q0A
HP MFP Analog Fax 703 Accessory (BBU option code only)	1M0Q1A
HP LaserJet Workflow Accelerator Card (only compatible with Flow models)	1M0Q5A
HP Color LaserJet Stand	6QN54A
HP Color LaserJet Storage Stand	6QN55A
HP Color LaserJet 550-sheet Paper Tray	6QN57A
HP Color LaserJet 2,100 HCI Feeder and Stand	6QN58A
HP LaserJet A5 HCI Guide Kit	616G9A
HP LaserJet Statement HCI Guide Kit (only compatible with Flow models)	616H0A
HP LaserJet Workflow Keyboard (only compatible with Flow models)	1M0Q2A
HP LaserJet Workflow UK Keyboard	616H2A
HP USB Universal Card Reader	X3D03A
HP HIP2 Keystroke Reader	Y7C05A
HP Legic Secure USB Reader	4QL32A
HP HID Mob Acc Mifare DES Fire ks Reader	35H11A
HP 500GB CCC FIPS Hard Disk Drive	9EQ11A
HP Jetdirect 3100w BLE/NFC/Wireless	3JN69A
HP Color LaserJet X677 Constellation Yellow Color Panel Kit	630C2A
HP Color LaserJet X677 Cosmic Green Color Panel Kit	630C3A
HP Color LaserJet X677 Aurora Purple Color Panel Kit	630C4A
HP Color LaserJet X677 Comet Red Color Panel Kit	630C5A
HP Color LaserJet X677 Lunar Gray Color Panel Kit	630C6A
HP 550-sheet Paper Tray Constellation Yellow Panel Kit	630C7A
HP 550-sheet Paper Tray Cosmic Green Panel Kit	630C8A
HP 550-sheet Paper Tray Aurora Purple Panel Kit	630C9A
HP 550-sheet Paper Tray Comet Red Panel Kit	630D0A
HP 550-sheet Paper Tray Lunar Gray Panel Kit	630D1A
HP HC Tray Constellation Yellow Panel Kit	630D2A
HP HC Tray Cosmic Green Panel Kit	630D3A
HP HC Tray Aurora Purple Panel Kit	630D4A
HP HC Tray Comet Red Panel Kit	630D5A
HP HC Tray Lunar Gray Panel Kit	630D6A
HP Storage Stand Constellation Yellow Panel Kit	630D7A
HP Storage Stand Cosmic Green Panel Kit	630D8A

X677 accessories

HP Storage Stand Aurora Purple Panel Kit	630D9A
HP Storage Stand Comet Red Panel Kit	630F0A
HP Storage Stand Lunar Gray Panel Kit	630F1A
HP Color LaserJet Constellation Yellow 550 sheet Paper Tray	65A28A
HP Color LaserJet Cosmic Green 550-sheet Paper Tray	65A29A
HP Color LaserJet Aurora Purple 550-sheet Paper Tray	65A30A
HP Color LaserJet Comet Red 550-sheet Paper Tray	65A31A
HP Color LaserJet Lunar Gray 550-sheet Paper Tray	65A32A
HP Color LaserJet Constellation Yellow 2,100-sheet High capacity Paper Tray/Stand	65A33A
HP Color LaserJet Cosmic Green 2,100-sheet High capacity Paper Tray/Stand	65A34A
HP Color LaserJet Aurora Purple 2,100-sheet High capacity Paper Tray/Stand	65A35A
HP Color LaserJet Comet Red 2,100-sheet High capacity Paper Tray/Stand	65A36A
HP Color LaserJet Lunar Gray 2,100-sheet High capacity Paper Tray/Stand	65A37A
HP Color LaserJet Constellation Yellow Storage Stand	65A38A
HP Color LaserJet Cosmic Green Storage Stand	65A39A
HP Color LaserJet Aurora Purple Storage Stand	65A40A
HP Color LaserJet Comet Red Storage Stand	65A41A
HP Color LaserJet Lunar Gray Storage Stand	65A42A

Configuration

HP Color LaserJet Enterprise X677 series

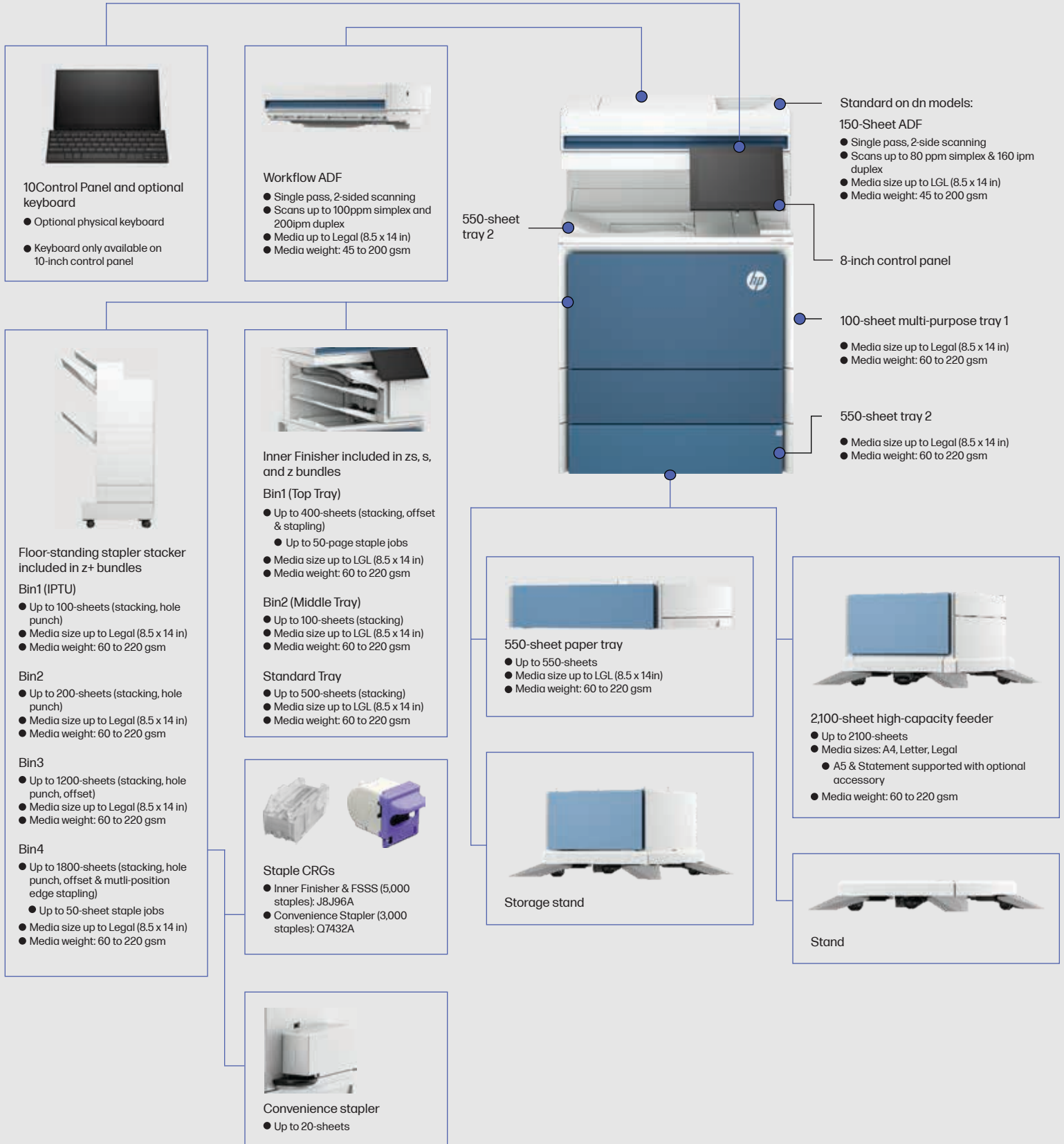

Paper handling accessories

Stand and input devices

Paper input and stand options



Product number	6QN57A	6QN54A	6QN55A	6QN58A
Product description	HP Color LaserJet 550 sheet paper tray	HP Color LaserJet stand	HP Color LaserJet storage stand	HP Color LaserJet 2100 high capacity feeder and stand
Configuration: X677dn	Compatible (up to 3 or 1 if storage stand or HCI is added) Desktop: Recommended add up to 1	Compatible Recommended: Add stand if 3x 550 trays are added	Compatible	Compatible
Configuration: X677zs	Built in hardware (2)	Built in hardware	N/A	N/A
Configuration: X677s/X677z	Compatible (up to 2 or 0 if Storage Stand or HCI is added) Desktop: Not recommended to add	Compatible Recommended: Add stand if 1 550 tray is added	Compatible	Compatible
Configuration: X677z+	Built in hardware (1)	N/A	N/A	Built in hardware



© Copyright 2023 HP Development Company, L.P. The information contained herein is subject to change without notice. The only warranties for HP products and services are set forth in the express warranty statements accompanying such products and services. Nothing herein should be construed as constituting an additional warranty. HP shall not be liable for technical or editorial errors or omissions contained herein.

The only warranties for HP products and services are set forth in the express warranty statements accompanying such products and services. Nothing herein should be construed as constituting an additional warranty. HP shall not be liable for technical or editorial errors or omissions contained herein. No HP trademark notice is required, nor is any acknowledgement of another party's trademarks unless we are contractually obligated to do so, e.g., Microsoft or Intel MDF program commitments. See the Trademarks website for the list of such marks.